

The
"Hornet Special"

SIX - CYLINDER

SPARE PART LIST No. 928
FOR
CHASSIS SUPPLIED TO COACHBUILDERS

WOLSBLEY MOTORS (1927) LTD., WARD END, BIRMINGHAM, 8
General Director - - SEE WILLIAM R. MORRIS, ET.

WOLSELEY MOTORS (1927) LIMITED

Governing Director - - SIR WILLIAM R. MORRIS, BT.

The
“Hornet Special”

SIX - CYLINDER

SPARE PART LIST No. 928

FOR

CHASSIS SUPPLIED TO COACHBUILDERS

Head Office and Works - - DREWS LANE, WARD END, BIRMINGHAM, 8

Telegrams - - - - "EXACTITUDE, BIRMINGHAM"

Telephone - - - - BIRMINGHAM EAST 1501

London Repair Works - - - - EUSTACE WATKINS LTD., MANOR STREET, CHELSEA, S.W.

Telegrams & Telephone - - - - FLAXMAN 8281 (10 lines)

CONTENTS

<p>AXLES AND WHEELS</p> <p>Front Axle ... 25</p> <p>Front Hub ... 25</p> <p>Rear Axle ... 23</p> <p>Rear Hub ... 23</p> <p>Road Wheels ... 23</p> <p>BRAKES</p> <p>Front Wheel Brake ... 27</p> <p>Rear Wheel Brake ... 27</p> <p>BONNET FITTINGS ... 35</p> <p>CLUTCH ... 21</p> <p>DASHBOARD ... 35</p> <p>ENGINE</p> <p>Crankcase and Cylinders ... 5</p> <p>Cylinder Head ... 9</p> <p>Crankshaft and Bearings ... 7</p> <p>Camshaft and Bearings ... 9</p> <p>Connecting Rods and Pistons ... 7</p> <p>Carburettor ... 17</p> <p>Chains and Wheels ... 11</p> <p>Dynamo Drive ... 15</p> <p>Distributor Drive ... 11</p> <p>Engine Support Details ... 5</p> <p>Exhaust Manifold ... 17</p> <p>Ignition and Control ... 15, 20</p> <p>Oil Base ... 5</p> <p>Oil Pump ... 11</p> <p>Oil Strainer ... 13</p> <p>Oil Filler ... 13</p> <p>Oil Pipes ... 13</p> <p>Oil Cooler ... 13</p> <p>Oil Cleaner ... 13</p> <p>Valves and Valve Springs ... 9</p> <p>Valve Rockers and Shafts ... 9</p> <p>Water Inlet Pipe ... 5</p> <p>Water Pump ... 11</p> <p>ELECTRICAL EQUIPMENT</p> <p>Battery ... 15</p> <p>Dynamo ... 15</p>	<p>ELECTRICAL EQUIPMENT—continued</p> <p>Distributor ... 15</p> <p>Electric Horn ... 15</p> <p>Instrument Panel ... 15</p> <p>Lamps ... 15</p> <p>Starter and Switch ... 15</p> <p>FRAME AND FITTINGS ... 33</p> <p>FOOT CONTROL</p> <p>Accelerator ... 17</p> <p>Brakes ... 31</p> <p>Clutch ... 19</p> <p>GEARBOX</p> <p>Bearings ... 21</p> <p>Gearcase and Covers ... 19</p> <p>Gears and Shafts ... 21</p> <p>HAND CONTROL</p> <p>Brake ... 31</p> <p>Change Speed ... 19</p> <p>Ignition ... 20</p> <p>Throttle ... 17</p> <p>IGNITION ... 15, 20</p> <p>PROPELLER SHAFT AND UNIVERSAL JOINTS ... 23</p> <p>PETROL TANK</p> <p>Petrol Tank ... 35</p> <p>Petrol Pipes ... 35</p> <p>ROAD SPRINGS AND SUSPENSION ... 33</p> <p>RADIATOR AND FITTINGS ... 35</p> <p>STEERING ... 25, 29</p> <p>SILENCER AND EXHAUST PIPES ... 35</p> <p>SHOCK ABSORBERS AND FITTINGS ... 33</p> <p>TOOL KIT ... 36</p>
--------------------------------------------------------------------------------------------------------------------------------------------------------------------------------------------------------------------------------------------------------------------------------------------------------------------------------------------------------------------------------------------------------------------------------------------------------------------------------------------------------------------------------------------------------------------------------------------------------------------------------------------------------------------------------------------------------------------------------------------------------------------------------------------------------------------------------------------------------------------------------------------------------------------------------------------------------------------------------------------------------------------------------------------------------------------------------------------------------------------------------------------------------------------------------	--------------------------------------------------------------------------------------------------------------------------------------------------------------------------------------------------------------------------------------------------------------------------------------------------------------------------------------------------------------------------------------------------------------------------------------------------------------------------------------------------------------------------------------------------------------------------------------------------------------------------------------------------------------------------------------------------------------------------------------------------------------------------------------------------------------------------------------------------------------------------------------------------------------------------------------------------------------------------------------------------------------

WOLSELEY "HORNET SPECIAL" SIX-CYLINDER

(For Chassis supplied to Coachbuilders)

INTRODUCTION

THIS list of Spares for the Wolseley "Hornet Special" has been compiled in order to facilitate the ordering of parts which require replacement. The parts are grouped into components, and all the principal pieces are illustrated. When ordering, clients should quote the Service Number, together with the description of the part, in order to minimise the possibility of error.

We would particularly impress upon clients the importance of always quoting the MAKER'S CAR NUMBER (not Registration Number), which will be found on the metal name-plate on the Dashboard Shroud under the Bonnet. The ENGINE NUMBER will be found on the Engine Case (Near-side Rear), and should be quoted in addition to the Car Number when ordering Engine spares. The CHASSIS NUMBER will be found on the Dashboard Shroud under the Bonnet and should be quoted in addition to the Car Number when ordering Chassis spares.

We reserve to ourselves the right to alter any part as may be considered advantageous, and therefore it is possible that illustrations shown in this book may not in all cases exactly resemble the actual part required.

All parts sent to be repaired must be forwarded carriage paid. These may be forwarded to either of the addresses on the title page, and must bear the Sender's Name, Address, and Maker's Car Number.

All parts sent for repairs are acknowledged as soon as received.

To avoid delay, customers with whom we have no ledger account should send cash with order.

See separate Schedule for Prices.

Instruction Manual shows List of Service Stations for Proprietary Articles.

In order to assist customers who desire to send a telegram, we give below the telegraphic codes referring to service matters—

YAKD	...	Wolseley "Hornet" Car No.....
SEREB	...	Referring to your communication Service Manager dated.....
SEREM	...	Referring to your communication Estimating dated.....
SEREP	...	Referring to your communication General Office dated.....
SERFU	...	Despatch immediately per post and charge our account for Car No.....
SERGI	...	Despatch immediately per passenger train and charge our account for Car No.....
SERJO	...	Despatch per post direct to Customer and charge our account for Car No.....
SERKS	...	Despatch per passenger train direct to Customer and charge our account for Car No.....
SERMY	...	Advise delivery date for our Order No.....
SERNA	...	Please quote but do not supply pending official order for following spares for Car No.....
SEROT	...	Can you supply from stock for Car No.....
SERSK	...	Priced invoice to be sent with spares.
SERTE	...	Complete with all fittings.
SERUS	...	With studs and nuts only.
SERYL	...	Complete with bearings.
C.O.D.	...	Cash on Delivery.

WOLSELEY MOTORS (1927) LTD.

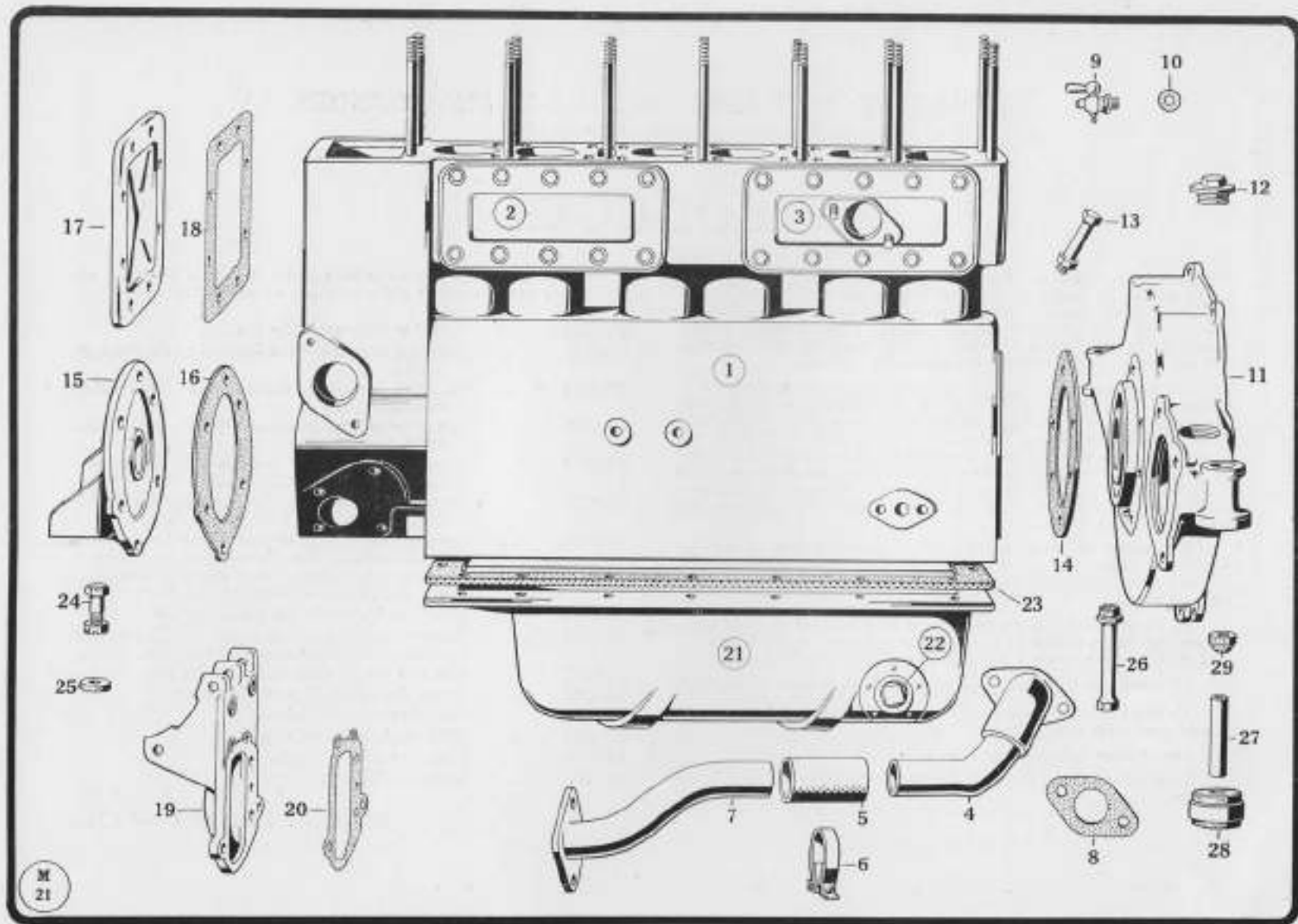

WOLSELEY "HORNET SPECIAL" SIX-CYLINDER

Crankcase, Oilbase and Engine Support Details

No. of Illustration.	Service No. for ordering.	Description of Part.	No. of Illustration.	Service No. for ordering.	Description of Part.	
		Crankcase and Cylinders				
1	{	M4001A		14	M119-1	Joint for Bell Housing
		M4002A	Crankcase and Cylinders complete with Water Jacket, Covers and Main Bearings ("A" Type)	—	M127	Set Screw for Bell Housing to Crankcase
				15	M2020A	Front Cover and Engine Front Support
				16	M2021	Joint for Front Cover
2		M7	Cover-plate for Cylinder Jacket (Front)	17	M2022	Cover for Chain Case
3		M8A	Cover-plate for Cylinder Jacket (Rear) complete with Flange and Studs	18	M2023	Joint for Chain Case Cover
—		M9-1	Joint for Cover-plates (Front or Rear)			<i>Note:—For Engine Chains and Wheels see Page 11.</i>
—		M10	Set Screw for Cover-plates	19	M2024A	Dynamo Support Bracket and Chain Case Cover
4		M2008A-1	Water Inlet Pipe (Rear Portion) (Chromium Plated)	—	M2026	Packing Shim for Dynamo Support Bracket
5		M2009	Rubber Hose for Inlet Pipes	20	M2025	Joint for Dynamo Support Bracket
6		M1511-1	Clip for Rubber Hose (Chromium Plated)			<i>Note:—For Dynamo and Fittings see Page 15.</i>
7		M2011A-1	Water Inlet Pipe (Front Portion) (Chromium Plated)			Oil Base
8		M12	Joint for Water Inlet Pipe	21	M2031A	Oil Base complete
			<i>Note:—For Rubber Hose see Page 35.</i>	22	M42	Drain Plug for Oil Base
9		G33	Drain Cock in Cylinder Wall	23	M43	Joint for Oil Base
10		E260	Washer for Drain Cock	—	M432	Set Screw for Oil Base to Crankcase
11		M2015A-1	Bell Housing complete with Main Bearing			Engine Support Details
12		M16	Plug for Bell Housing (Starter Pinion Inspection)	24	M51A	Front Engine Holding-down Bolt, Nut and Washers
13		M18A	Clutch Pedal Stop Pin in Bell Housing with Lock Nut	25	M52	Rubber Seating Block for Engine (Front)
			<i>Note:—For Clutch Pedal see Page 10.</i>	26	M53A	Rear Engine Holding-down Bolt, Nut and Washer
				27	M54	Distance Piece for Bolt
				28	M55	Rubber Seating Block for Rear Engine Arm complete with Metal Ring
				29	M56	Coned Rubber Seat for Rear Engine Holding-down Bolt

Please state maker's CAR NUMBER and ENGINE NUMBER when ordering. See note on Page 3. Prices of Spare Parts are shown on separate list.

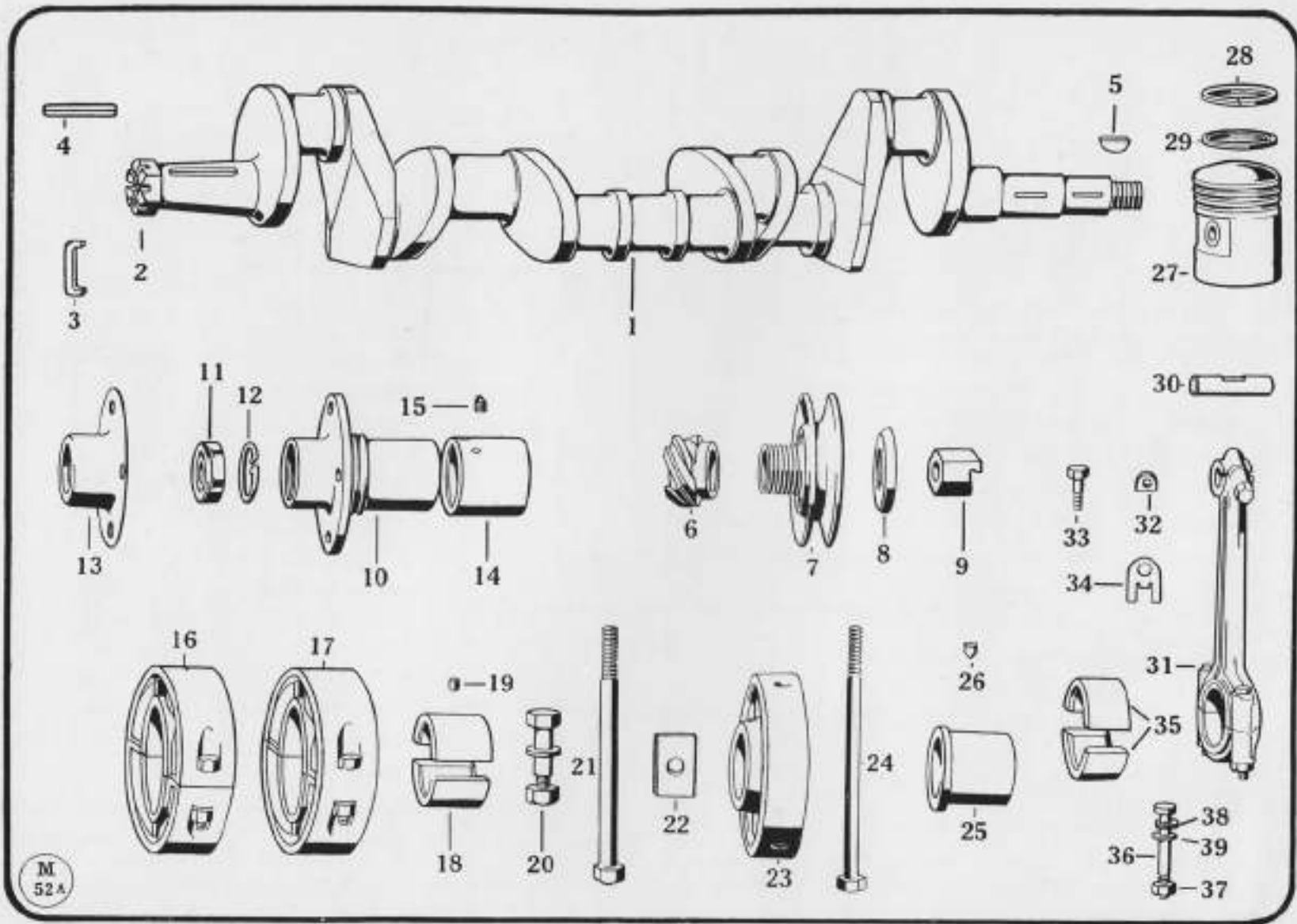

WOLSELEY "HORNET SPECIAL" SIX-CYLINDER

Crankshaft and Bearings, Connecting Rod and Piston

No. of Illustration.	Service No. for ordering.	Description of Part.	No. of Illustration.	Service No. for ordering.	Description of Part.
Crankshaft			Connecting Rod and Piston		
1	M2101A	Crankshaft complete with Keys and Flange Retaining Nut and Locking Wire	—	M2141A—2	Piston complete with Rings "A" Type
2	M102	Flange Retaining Nut on Crankshaft	—	M2142A—2	Piston complete with Rings "B" Type
3	M103	Locking Wire for Nut			
4	M104	Key for Driving Flange	27	M2144—2	Piston only (less Rings) "A" Type
5	M105	Woodruff Key for Crankshaft (front end)		M2145—2	Piston only (less Rings) "B" Type
6	M2106	Spiral Driving Gear for Oil and Water Pumps			
7	M2107	Dynamo Driver Pulley	28	M147	Piston Ring "A" Type
8	M2122	Oil Thrower for Crankshaft (front end)		M148	Piston Ring "B" Type
9	M117	Starting Dog			
10	M118	Driving Flange on Rear End of Crankshaft	29	M150	Scraper Ring "A" Type
11	M119	Ball Bearing in Driving Flange		M151	Scraper Ring "B" Type
12	M120	Locking Wire for Ball Bearing	30	M153	Gudgeon Pin
13	M865	Oil Retainer for Ball Bearing	31	M154A	Connecting Rod complete with Cap and Big-end Bush
Bearings and Housings			32	M155	Locking Plate for Gudgeon Pin
14	M121—1	Bearing for Crankshaft (rear end)	33	M156—1	Pinching Bolt for Small-end
15	M122	Screw for Locking Rear End Bearing	34	M157	Tab Locking Washer for Pinching Bolt
—	M123A	Housing for Intermediate Bearing (rear) complete with Bush	35	M158A	Bearing Bush for Big-end (Two Halves)
16	M125A	Housing for Intermediate Bearing (rear) less Bush	36	M160—2	Bolt for Connecting Rod Big-end
—	M126A	Housing for Intermediate Bearing (front) complete with Bush	37	M161—1	Nut for Bolt
17	M126A	Housing for Intermediate Bearing (front) less Bush	38	M162	Washer for Bolt Head
18	M129A	Bearing Bush for Crankshaft (Intermediate) Two Halves	39	M163—1	Washer for Nut
19	M130	Dowel for Bearing Bushes			
20	M131A	Bolt, Nut and Washer for Bearing Housings			
21	M2132	Holding-down Bolt for Intermediate Bearing Housings			
22	M133	Lock Plate for Holding-down Bolt			
23	M2124	Housing for Front Crankshaft Bearing			
24	M2125	Holding-down Bolt (Near-side) for Front Bearing Housing			
21	M2132	Holding-down Bolt (Off-side) for Front Bearing Housing			
25	M2127	Bearing Bush for Crankshaft (front end)	—	M2171A—2	Connecting Rod and Piston complete "A" Type
26	M2128	Dowel for Front Bearing Bush	—	M2172A—2	Connecting Rod and Piston complete "B" Type
		<i>Note:—For Flywheel see Page 24.</i>	—	M174A	Bolt, Nut, Washer and Split Pin for Connecting Rod Big-end
			Sub-Assemblies		

Please state maker's CAR NUMBER and ENGINE NUMBER when ordering. See note on Page 3. Prices of Spare Parts are shown on separate list.

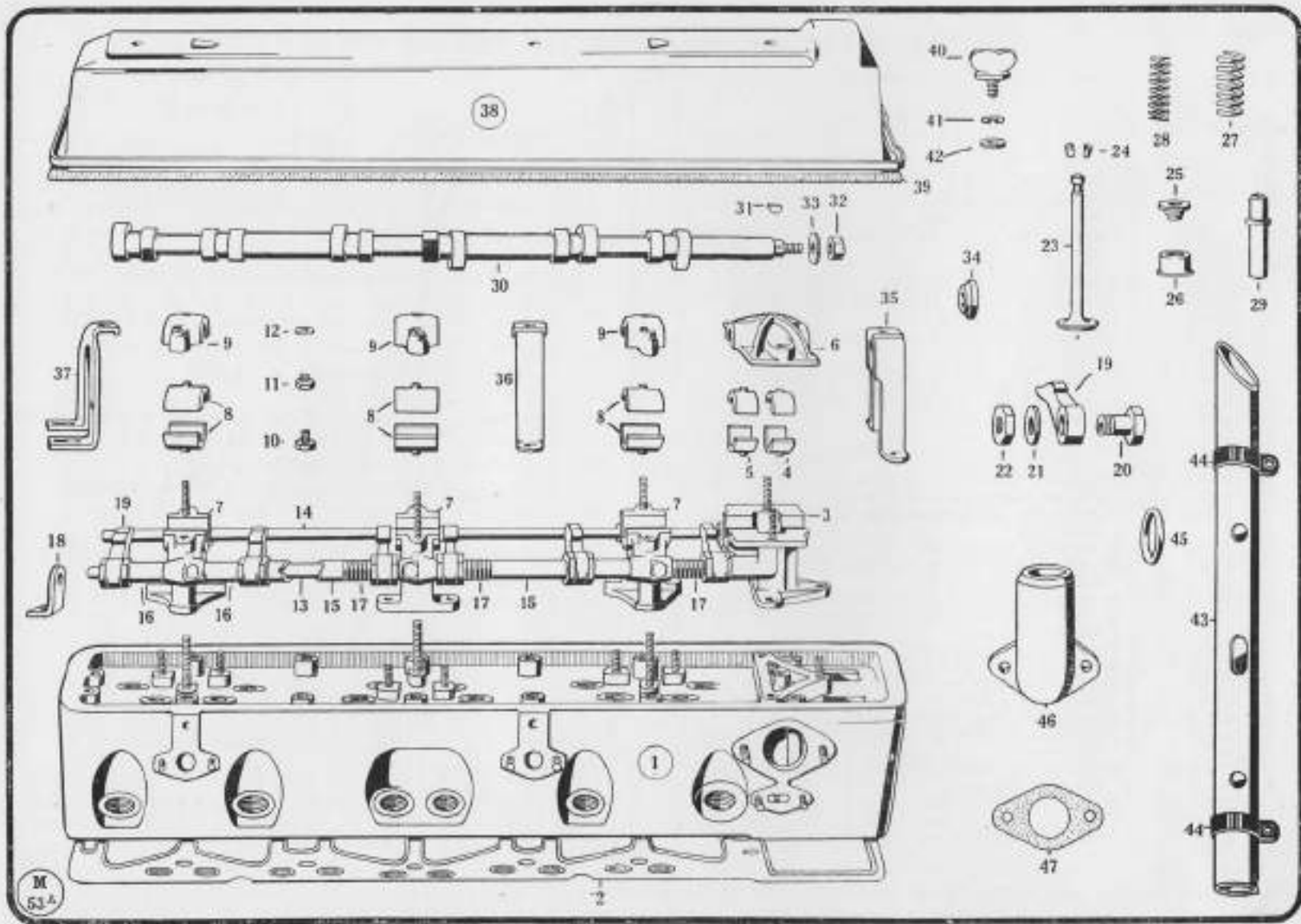

WOLSELEY "HORNET SPECIAL" SIX-CYLINDER

Cylinder Head, Camshaft, Valves, etc.

No. of Illustration.	Service No. for ordering.	Description of Part.	No. of Illustration.	Service No. for ordering.	Description of Part.
Cylinder Head					
1	M2201A-1	Cylinder Head (studded)	28	M2228	Valve Spring (Inner)
2	M2202	Joint for Cylinder Head	29	M231-1	Valve Guide
3	M2203A-1	Camshaft Front Bearing Housing with Cap	Camshaft		
4	M205A	Front Bush for Front Camshaft Bearing Housing (Two Halves) [(Two Halves)]	30	M2229A-1	Camshaft complete with Nut, Washer and Key
5	M206A	Rear Bush for Front Camshaft Bearing Housing	31	F229	Key for Camshaft
6	M2206-1	Cap for Front Bearing Housing	32	M234	Nut for Camshaft
7	M209A	Camshaft Bearing Housing (Intermediate or Rear) with Cap	33	M235	Washer for Camshaft
8	M210A	Bush for Bearing Housing (Intermediate or Rear) (Two Halves)	34	M2233	Distance Collar for Camshaft <i>Note:—For Camshaft Chain Wheel see Page II.</i>
9	M211	Cap for Bearing Housing (Intermediate or Rear)	Cylinder Head Cover		
10	M212	Locking Screw for Rocker Shaft (Rear End Bearing Housing)	35	M239A	Strap for Cylinder Head Cover (Front)
11	M213	Plug for Bearing Housing (Intermediate)	36	M242A	Strap for Cylinder Head Cover (Centre)
12	M214	Washer for Locking Screw or Plug in Bearing Housings	37	M245A-1	Strap for Cylinder Head Cover (Rear)
13	M215A	Shaft for Valve Rockers (Off-side)	38	M2237A-1	Cover for Cylinder Head complete with Securing Nuts and Joint (Chromium Plated)
14	M216A	Shaft for Valve Rockers (Near-side)	39	M247	Joint for Cover
15	M217	Distance Piece for Rocker Shaft (Long)	40	M248-1	Wing Screw for Cylinder Head Cover (Chromium Plated)
16	M218	Distance Piece for Rocker Shaft (Short)	41	M249	Spring Ring for Wing Screw
17	M219	Distance Spring for Rocker Shaft	42	M250	Copper Washer
18	M220	Steady Bracket for Rocker Shaft (Off-side Rear End)	Ignition Wire Tube and Water Outlet Pipe		
Valves and Valve Rockers					
19	M222	Valve Rocker Arm	43	M2242	Ignition Wire Tube
20	M223	Eccentric Bush for Valve Rocker	44	G135	Clip for Ignition Wire Tube
21	M224	Locking Washer for Valve Rocker	45	M253	Rubber Ring for Ignition Wires
22	M225	Locking Nut for Eccentric Bush	46	M2245-1	Water Outlet Pipe
23	M236-1	Inlet or Exhaust Valve	47	M2246	Joint for Water Outlet Pipe
24	M227	Split Collar for Valve (Two Halves)	Sub-Assemblies		
25	M228-1	Valve Spring Cup	—	M2281A-1	Cylinder Head complete with Camshaft, Valves, etc., and Camshaft Driving Pinion
26	M229	Valve Spring Cover	—	M2282A-1	Camshaft Front Bearing Housing complete with Cap and Bush
27	M230-1	Valve Spring (Outer)	—	M283A	Camshaft Bearing Housing (Intermediate or Rear complete with Cap and Bush) [Lock Nut
			—	M284A	Valve Rocker complete with Eccentric Bush and

Please state maker's CAR NUMBER and ENGINE NUMBER when ordering. See note on Page 3. Prices of Spare Parts are shown on separate list.

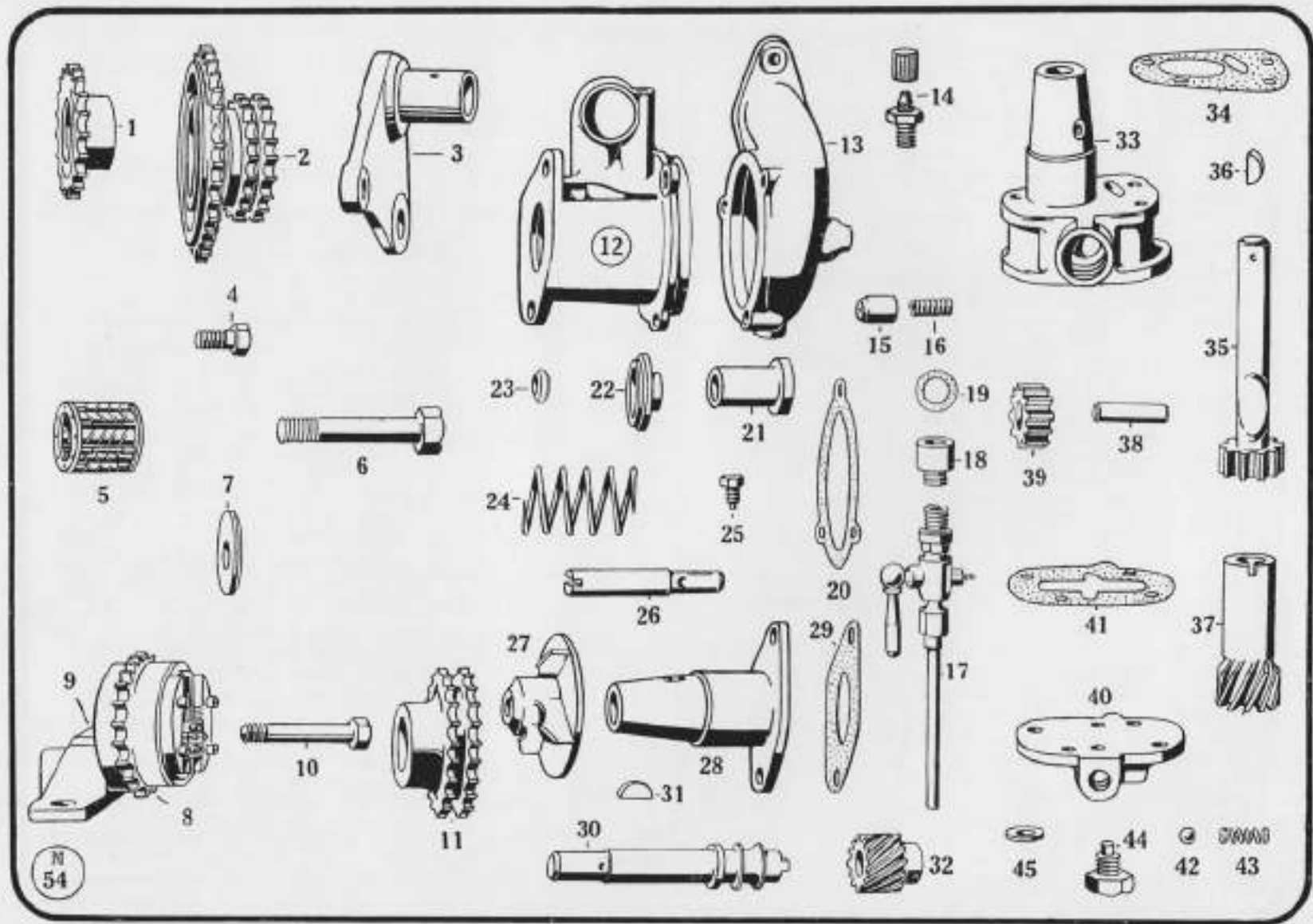

WOLSELEY "HORNET SPECIAL" SIX-CYLINDER

Engine Chains, Chain Wheels and Fittings, Water Pump and Oil Pump Details

No. of Illustration.	Service No. for ordering.	Description of Part.	No. of Illustration.	Service No. for ordering.	Description of Part.
Engine Chains and Wheels					
1	M2301—1	Crankshaft Chain Wheel	25	F125	Locking Screw for Bush
—	M2302	Single Roller Chain (Endless)	26	M2342	Water Pump Spindle
2	M2303A	Countershaft Chain Wheel complete	27	M2344	Pump Rotor
3	V3304	Support Bracket for Countershaft Chain Wheel	—	M2345A	Pump Spindle assembled with Rotor
4	V3305	Set Screw for Support Bracket	28	M2346	Bracket for Water Pump Spindle
5	V3309	Roller Bearing for Countershaft Chain Wheel	29	M2347	Joint for Bracket
6	M2308	Locking Bolt for Roller Bearing	30	M2348—1	Driving Shaft for Water Pump
7	V3311	Thrust Washer for Locking Bolt	31	H189	Key for Driven Gear
8	M2310	Tensioner Chain Wheel	32	M2350	Spiral Driven Gear for Water Pump
9	M2318A	Chain Tensioner complete with Wheel and Bracket	—	M2351A—1	Driving Shaft complete with Spiral Gear
10	M4313	Bolt for Tensioner Bracket	—	M2361A	Water Pump complete
—	M2314	Duplex Roller Chain	Oil Pump		
—	M2315	Connecting Link and Spring Clip for Duplex Chain	33	M2371	Oil Pump Body
—	M2317	Spring Clip for Connecting Link	34	M2372	Joint Oil Pump Body
11	M2316—1	Camshaft Chain Wheel	35	M2373	Oil Pump Spindle
Water Pump					
12	M2331A—1	Water Pump Body (Bushed)	36	H189	Key for Spindle
13	M2332A	Cover for Water Pump Body (Studded)	37	M2375	Oil Pump Spiral Driven Gear
—	M2333	Bolt for Water Outlet Flange	38	M2376	Idle Spindle for Driven Gear
14	M2334	Greaser Nipple for Body or Cover	39	M357	Oil Pump Driven Gear
15	M2336	Plunger for Pump Rotor	40	M2378	Oil Pump Cover
16	M2337	Spring for Plunger	41	M2379	Joint for Cover
17	M1504	Drain Tap for Water Pump Cover	42	M2380	Ball for Relief Valve
18	M4338	Adaptor for Drain Tap	43	M2381—1	Spring for Relief Valve
19	GD12	Washer for Drain Tap or Adaptor	44	M2382—1	Plug for Relief Valve
20	M2339	Joint for Pump Body and Cover	45	H209	Washer for Plug
21	M2340—1	Bush in Pump Body	—	M2391A—1	Oil Pump complete with Relief Valve and Spiral Gear
22	M2352	Gland Collar	<i>Note:—For Oil Pipes see Page 13.</i>		
23	M2353	Gland			
24	M2354	Spring for Gland			

Please state maker's CAR NUMBER and ENGINE NUMBER when ordering. See note on Page 3. Prices of Spare Parts are shown on separate list.

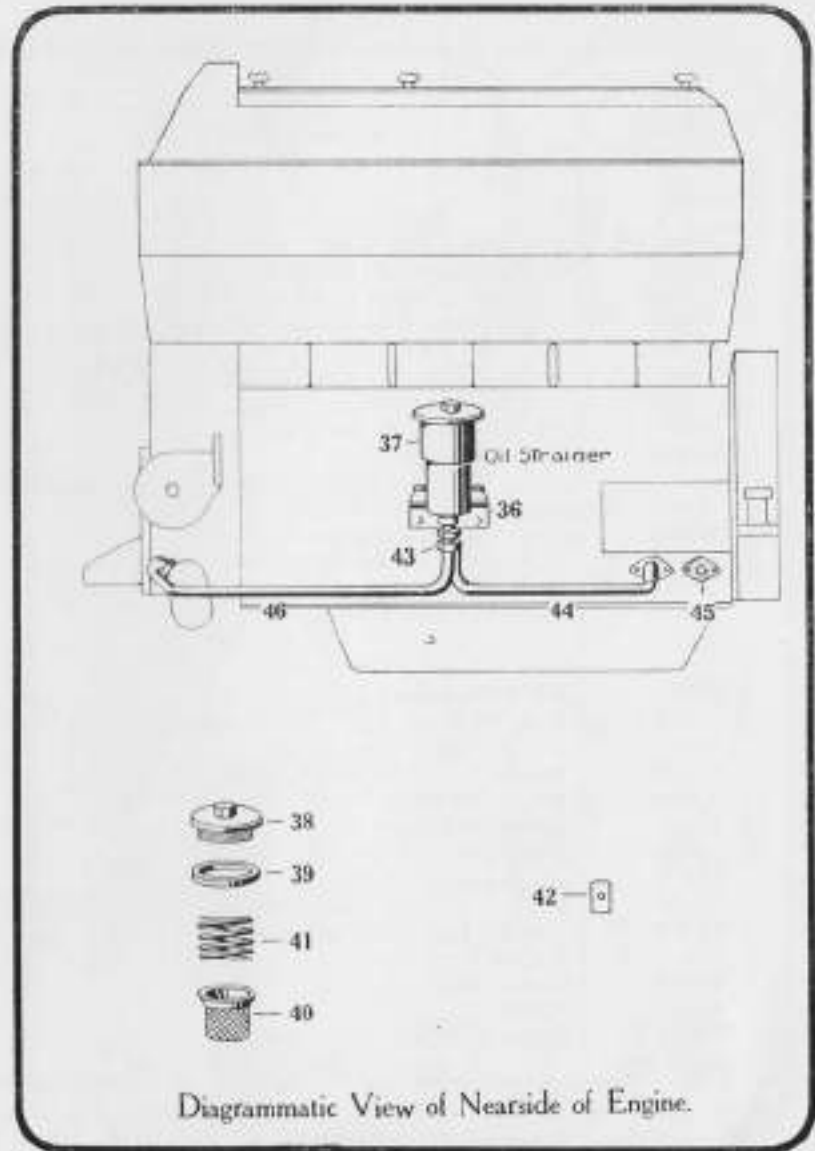
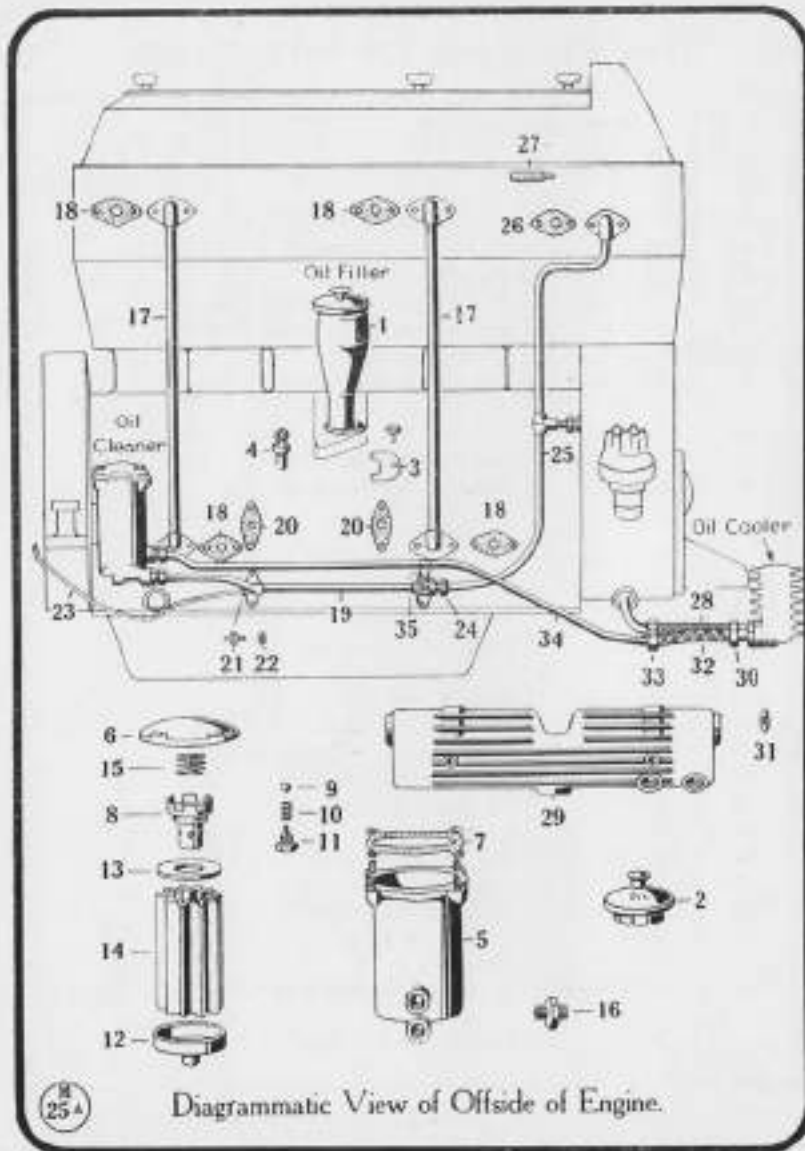

WOLSELEY "HORNET SPECIAL" SIX-CYLINDER

Oil Strainer, Oil Filler, Oil Cleaner, Oil Cooler and Oil Pipes

No. of Illustration.	Service No. for ordering.	Description of Part.	No. of Illustration.	Service No. for ordering.	Description of Part.
OFF-SIDE OF ENGINE			NEAR-SIDE OF ENGINE		
Oil Filler			Oil Strainer		
1	M2461	Oil Filler	36	M431	Bracket for Strainer
2	M2462	Cap for Oil Filler	—	M432	Screw for Bracket
3	M403	Clamp Plate for Oil Filler	—	E29A—1	Oil Strainer complete
Dip Stick			37	E30—2	Oil Strainer Body
4	M410	Oil Level Dip Stick	38	E31—3	Cover for Oil Strainer
Oil Cleaner			39	E52	Washer for Cover
5	M2463A	Oil Cleaner Case (Studded)	40	E37A—2	Oil Strainer Gauze
6	M2464	Cap for Oil Cleaner	41	E39	Spring for Strainer
7	M2465	Joint for Cap	42	E83	Locking Plate for Union
8	M2466	Oil Relief Valve Body	43	G305—1	Union for Strainer
9	M2467	Bronze Ball for Relief Valve	—	M441A	Bolt, Nut and Washer (Strainer to Bracket)
10	M2468	Spring for Relief Valve	—	M442	Screw for Locking Plate
11	M2469	Plug for Relief Valve	Oil Pipes		
12	M2470	Socket for Cleaner Element	44	M2451A	Oil Suction Pipe (Strainer to Crankcase) complete with Nut and Flange
13	M2471	Plate for Cleaner	45	G316	Joint for Oil Suction Pipe Flange (one inside Crankcase)
14	M2472	Oil Cleaner Element	—	M2453A	Oil Suction Pipe (inside Crankcase) with Flange
15	M2473	Spring for Element Location	46	M2454A	Oil Suction Pipe (Strainer to Pump) complete with Nuts
16	M2474	Union for Cleaner Case			
—	M2475A	Oil Cleaner complete			
Oil Pipes and Oil Cooler					
17	M2476A	Oil Drain Pipe (Centre or Rear) complete with Flanges			
18	V126	Joint for Drain Pipe Flanges			
19	M2477A	Main Feed Pipe complete with Flanges and Oil Cleaner Feed Pipe with Nut and Nipple			
20	M2481	Joint for Main Feed Pipe Flanges			
21	M422	Union in Feed Pipe Flange for Pressure Gauge Pipe			
22	M424	Washer for Union			
23	M2478A	Oil Pipe to Pressure Gauge complete with Nuts and Nipples			
24	M2479	Union in Feed Pipe Flange for Camshaft Feed			
25	M2480A	Feed Pipe to Chain Tensioner and Camshaft			
26	G317	Joint for Feed Pipe to Cylinder Head			
27	M2428	Oil Feed Restrictor			
28	M2481A	Oil Pipe (Pump to Cooler) with Flex. Pipe, Nuts and Nipples			
29	M2482A	Oil Cooler complete			
30	M2486	Union for Cooler			
31	M2487	Washer for Union			
32	M2488A	Flexible Pipe (Cooler to Cleaner) with Nuts and Nipples			
33	M2489	Union for Cleaner to Cooler Pipe			
34	M2490A	Pipe from Oil Cleaner to Oil Cooler Flex.			
35	M2491	Clip for Pipe			

Please state maker's CAR NUMBER and ENGINE NUMBER when ordering. See note on Page 3. Prices of Spare Parts are shown on separate list.

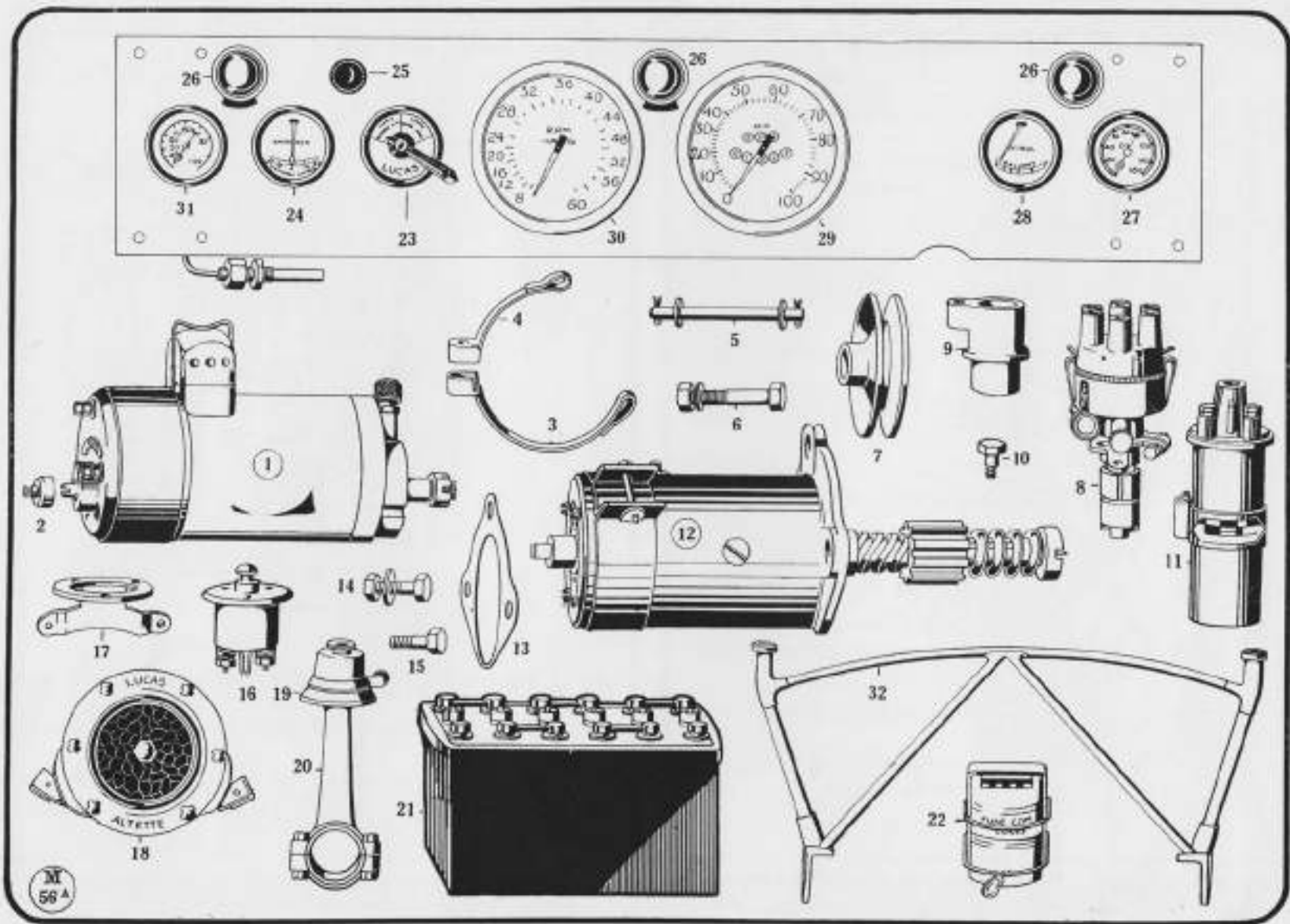

WOLSELEY "HORNET SPECIAL" SIX-CYLINDER

Electrical Equipment, also Instrument Board Fittings

No. of Illustration	Service No. for ordering	Description of Part	No. of Illustration	Service No. for ordering	Description of Part
Dynamo and Fittings					
1	M2501—2	Dynamo (Type E418A1) 12-volt	20	M2531A	Bracket for Combined Horn and Dip Switch
2	M2500—1	Adapter for Revolution Counter Drive	21	M519—1	Battery (Type STW11A—12) 12-volt
3	M2502	Strap for Dynamo (Bottom Half)	22	M2530	Cut-out (Type CF3) 12-volt
4	M2503	Strap for Dynamo (Top Half)	Instrument Board Fittings		
5	M2504A	Pin for Dynamo Straps	23	M2581	Switchboard
6	M2505A	Pinching Bolt, Nut and Washer for Dynamo Straps	24	M2582	Ammeter
7	V3510A	Pulley on Dynamo	25	M2583	Red Warning Light
—	M2507	Dynamo Driving Belt	—	M2559	Bulb for Warning Light
—	M2510	Screw-down Greaser for Dynamo	26	M2585	Dashlamp
<i>Note: For Dynamo Driving Pulley see Page 7.</i>					
Distribution and Ignition Wires					
8	M4508	Distributor (DJA6 Type) 12-volt	—	M2586	Bulb for Dashlamp
9	M2509	Adapter for Distributor	27	M534	Oil Gauge
10	M503	Securing Screw for Distributor	28	M2544—2	Petrol Gauge
—	M2511A	Set of Ignition Wires (High-tension)	29	M2589	Speedometer Head
—	M2512A	High-tension Wire (Coil to Distributor)	—	M2590	Flexible Shaft for Speedometer
11	M2515	Ignition Coil (12-volt)	30	M2502	Revolution Counter
—	M4511	Rubber Cap for Distributor	—	M2503	Cable for Revolution Counter
Starter and Details					
12	M507	Starter (Type M35AF)	31	M2594	Thermometer complete with Pipe
13	M508	Packing Piece for Starter	Lamps and Fittings		
14	M509A	Bolt, Nut and Washer (Starter to Bell Housing)	—	M2595	Headlamp (Near-side)
15	M510	Set Screw (Starter to Bell Housing)	—	M2596	Headlamp (Off-side)
16	M2520	Starter Switch (Type ST8) 12-volt	—	M2597	Bulb for Headlamp
17	M2521	Bracket for Starter Switch	32	M2598A	Headlamp Carrier complete
Electric Horn and Battery					
18	M2524A—2	Electric Horn	—	M2599	Sidelamp
19	M539	Combined Horn and Dip Switch (Type 15A)	—	M554	Bulb for Sidelamp
Electric Horn and Battery					
18	M2524A—2	Electric Horn	—	M2569	Stop- and Tail-lamp
19	M539	Combined Horn and Dip Switch (Type 15A)	—	M554	Bulb for Stop- and Tail-lamp

Please state maker's CAR NUMBER and ENGINE NUMBER when ordering. See note on page 3. Prices of Spare Parts are shown on separate list.

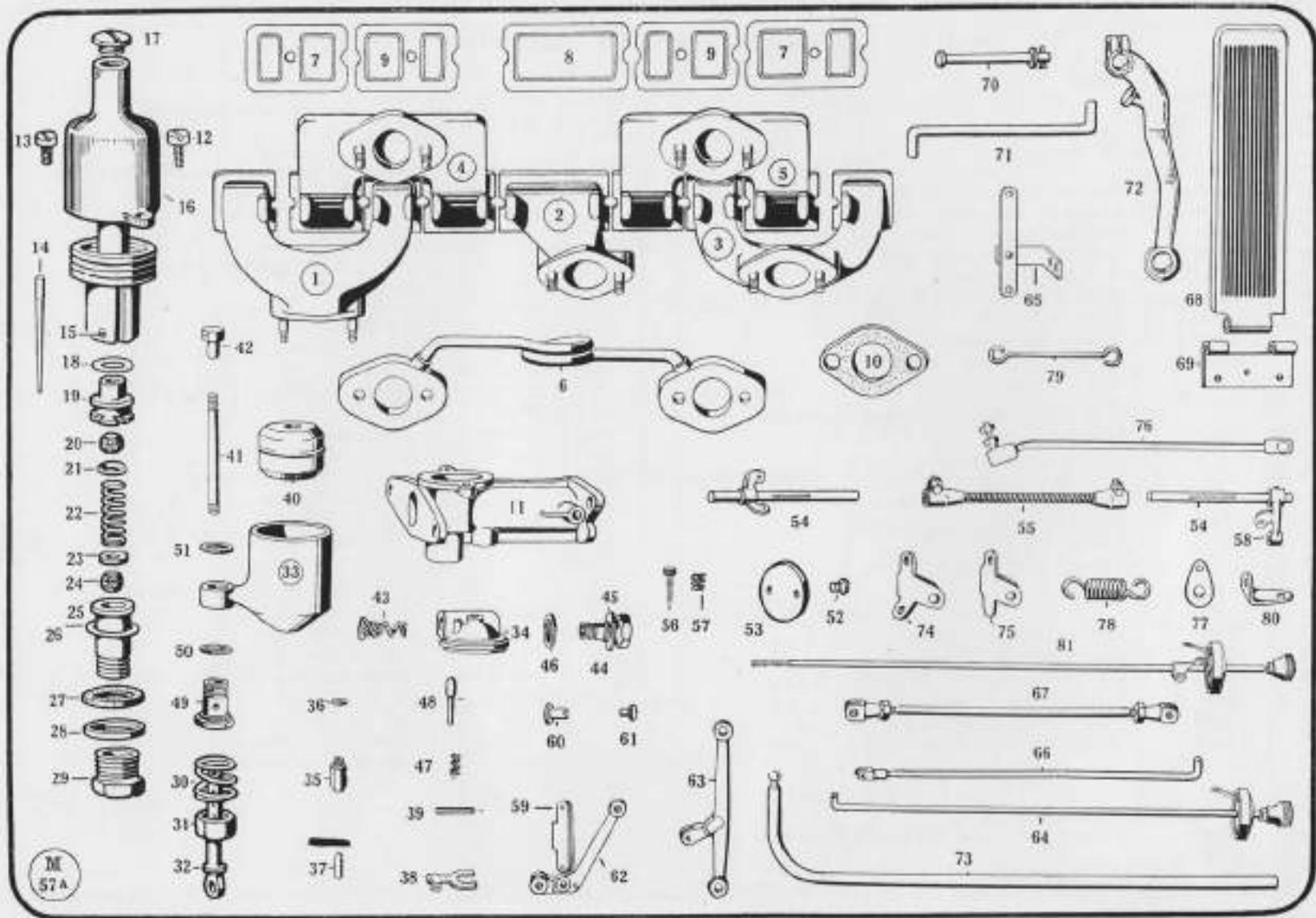

WOLSELEY "HORNET SPECIAL" SIX-CYLINDER

S.U. Carburetter (Adjustable Jet) and Control

No. of Illustration.	Service No. for ordering.	Description of Part.	No. of Illustration.	Service No. for ordering.	Description of Part.
Inlet and Exhaust Branch and Joints					
1	M2992A	Exhaust Manifold (Nos. 1 and 2 Cylinders) (Studded)	43	G472A	Strainer Gause and Spring
2	M2993A	Exhaust Manifold (Nos. 3 and 4 Cylinders) (Studded)	44	M4037	Range Pin for Float-chamber
3	M2994A	Exhaust Manifold (Nos. 5 and 6 Cylinders) (Studded)	45	M4028	Washer for Range (Outer)
4	M2995A	Inlet Branch (Front) (Studded)	46	M4039	Washer for Range (Inner)
5	M2996A	Inlet Branch (Rear) (Studded)	47	M4040	Spring for Float Ticker
6	M2997A	Balance Pipe with Flanges	48	M4041	Float Ticker Pin
7	M4032	Joint (Inlet and Exhaust) (No. 1 or No. 6 Cylinders)	49	M4042	Holding-up Bolt for Float-chamber
8	M4033	Joint (Inlet and Exhaust) (No. 3 and No. 4 Cylinders)	50	M4043	Washer for Holding-up Bolt (Outer)
9	M4034	Joint (Inlet and Exhaust) (No. 5 or No. 6 Cylinders)	51	M4044	Washer for Holding-up Bolt (Inner)
10	M2911	Joint for Carburetter or Balance Pipe Flanges	52	F458	Throttle Disc
Carburetter					
--	M4406A-1	Carburetter complete	53	E427	Screw for Throttle Disc
11	M4407	Carburetter Body	54	M4528	Throttle Spindle
12	E364	Screw for securing Dashpot Cover (Long)	55	M2684A	Throttle Control Spring complete with Sleeves and Finching Bolts
13	E426	Screw for securing Dashpot Cover (Short)	56	M434	Adjusting Screw for Throttle Valve
14	M4698	Carburetter Needle	57	M2685	Spring for Adjusting Screw
15	M4699	Screw for Needle	58	M436	Throttle Control Lever
16	M4610A	Dashpot Piston and Dashpot	59	M444	Connecting Link for Jet Operating Lever
17	E316	Oil Cap	60	F422	Pin for Connecting Link (Long)
18	E424	Copper Washer (Top of Jet)	61	M2642	Pin for Connecting Link (Short)
19	E389	Jet Bearing (Top Half)	62	M445	Jet Operating Lever (Short)
20	E400	Cork Gland Washer (Top)	63	M2646	Jet Operating Lever (Long)
21	E401	Brass Gland Washer (Top)	Jet Control		
22	E402	Brass Gland Spring	64	M2671A-1	Jet Control Rod, Knob and Dial complete
23	E403	Brass Gland Washer (Bottom)	65	G475A-1	Jet Operating Link and Bracket
24	E404	Cork Gland Washer (Bottom)	66	M2672A-1	Control Link to Carburetter
25	E405	Jet Bearing (Bottom Half)	67	M2673A	Control Link between Carburetters with Jaws
26	E425	Copper Packing Washer for Bottom Bearing	Accelerator Pedal		
27	E404	Jet Sealing Washer (Cork)	68	M4671A	Accelerator Pedal
28	E405	Jet Sealing Washer (Brass)	69	M4672	Hinge for Accelerator Pedal
29	E406	Jet Screw	70	M4678A	Hinge Pin for Pedal with Washer and Split Pin
30	E407	Jet Adjusting Spring	71	M4674A-1	Control Rod (Pedal to Pedal Lever)
31	E409	Jet Adjusting Nut	72	M4675A-1	Accelerator Pedal Lever with Pinch Bolt
32	E409	Jet	73	M4676	Throttle Control Cross Shaft
33	M4426	Float-chamber	74	M4677A	Bracket on Dash for Cross Shaft (Off-side) (Flushed)
34	M4627	Lid for Float-chamber	75	M4678	Bracket on Dash for Cross Shaft (Near-side)
35	M4628	Float Needle Seat	76	M2686A	Throttle Connecting Link complete
36	M4629	Copper Washer for Float Needle Seat	77	M2687	Spring Anchor on Cross Shaft
37	M4630	Float Needle	78	M4679	Pull-off Spring
38	M4631	Hinged Lever for Float	79	M2688	Link for Pull-off Spring
39	M4632	Pin for Hinged Lever	80	M2689	Spring Anchor on Starter Bracket
40	M4633	Float	81	M2690A-1	Slow-running Control complete with Knob and Dial
41	M4634	Fixing Stud for Float-chamber Lid			
42	M4635	Fixing Nut for Float-chamber Lid			

Please state maker's CAR NUMBER and ENGINE NUMBER when ordering. See note on Page 3. Prices of Spare Parts are shown on separate list.

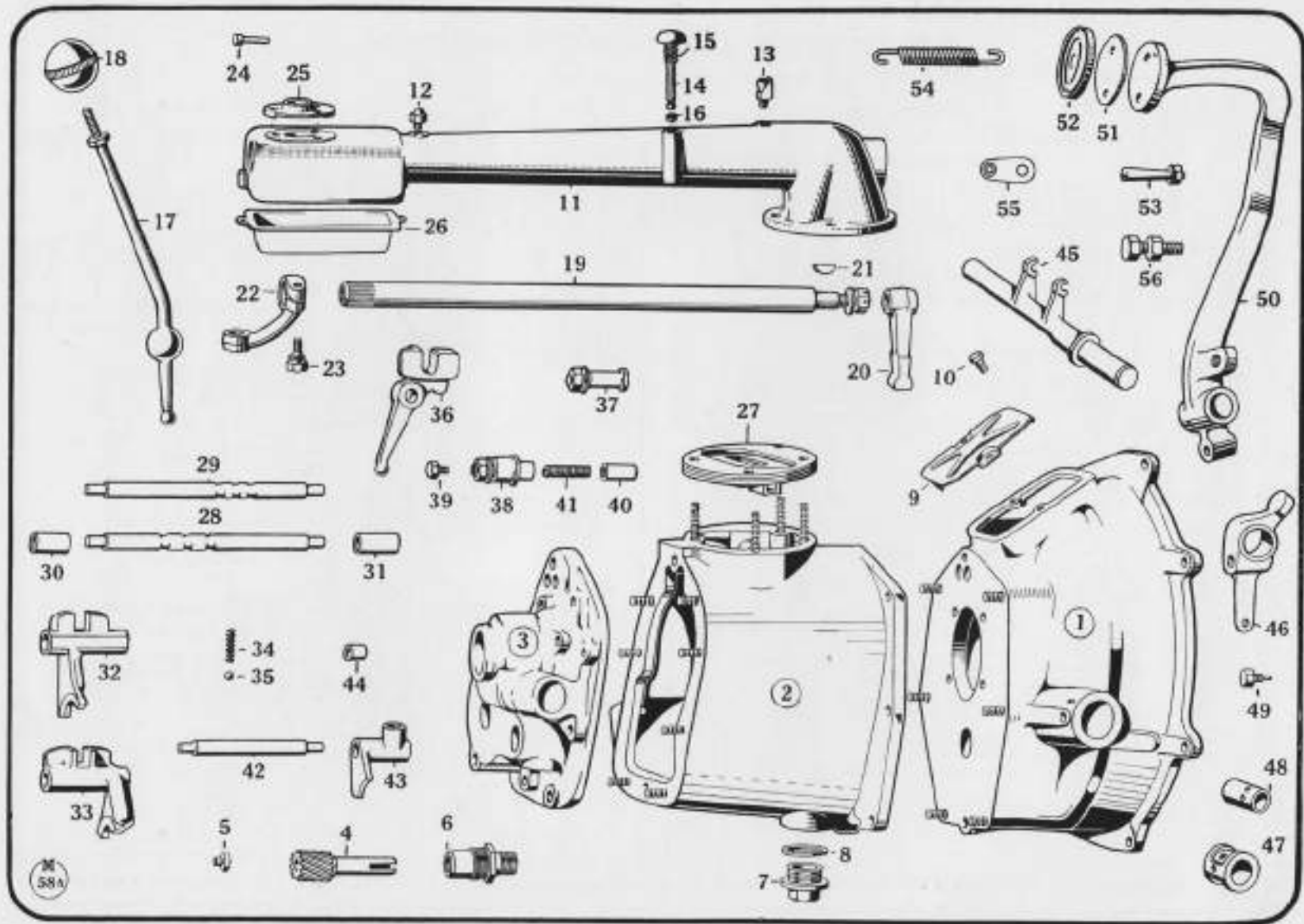

WOLSELEY "HORNET SPECIAL" SIX-CYLINDER

Gear Casing with Gear Operating Mechanism, and Clutch Pedal

No. of Illustration.	Service No. for ordering.	Description of Part.	No. of Illustration.	Service No. for ordering.	Description of Part.
Gearcase			Change Speed Rods and Forks		
1	M4701A	Clutch Pit (Studded)	28	M2728	First and Second Change Speed Rod
2	M2702A	Gearcase (Studded)	29	M2729	Third and Fourth Change Speed Rod
—	M4703A—1	Rear Cover complete with Speedometer Driven Gear	30	M2730	Distance Piece for First and Second Rod (Rear)
3	M4704A	Rear Cover	31	M2731	Distance Piece for First and Second Rod (Front)
4	M2705—1	Speedometer Driven Gear	32	M2732	First and Second Change Speed Fork
5	M707	Thrust Button for Speedometer Driven Gear	33	M2733	Third and Fourth Change Speed Fork
6	M708	Bearing for Speedometer Driven Gear	34	M738—1	Spring for Plunger Ball
7	M709	Plug for Gearcase (Filter or Drain)	35	M734	Plunger Ball
8	F211	Washer for Plug	36	M2736	Reverse Gear Operating Lever
9	M711	Inspection Cover for Clutch	37	M2737A	Pivot Pin for Reverse Lever with Nut and Washer
10	M10	Set Screw for Inspection Cover	38	M2738A—1	Socket for Reverse Locking Plunger with Nut, Washer and Plug
CHANGE SPEED MECHANISM			39	M2743	Plug for Socket
Top Cover, Hand Lever and Lock			40	M2749—1	Reverse Locking Plunger
11	M2751A—2	Change Speed Bracket (Studded)	41	M2740—2	Spring for Reverse Locking Plunger
12	M279	Greaser for Change Speed Bracket (Rear End)	42	M2741	Rod for Reverse Operating Fork
13	M1013—1	Greaser for Change Speed Bracket (Front End)	43	M2742	Reverse Operating Fork
14	M2754A—1	Plunger for Starter Switch with Knob and Ring	44	M730	Distance Piece for Reverse Operating Fork
15	M2755	Spring for Plunger	Clutch Operating Shaft and Pedal		
16	M2756	Spring Ring for Plunger	45	M4781	Clutch Operating Shaft
17	M2766	Change Speed Hand Lever	46	M4782	Clutch Shaft Lever
18	M2724	Knob for Hand Lever	47	M782	Bush for Operating Shaft (Off-side)
19	M2759A—2	Operating Tube for Change Speed with End Piece	48	M783A	Bush for Operating Shaft (Near-side)
20	M2761	Selector Lever	49	F125	Locking Screw for Bush
21	F229	Key for Selector Lever	50	M785—2	Clutch Pedal
22	M2767A	Change Speed Operating Lever with Pinch Bolt	51	M4784	Clutch Pedal Top
23	M2768	Pinch Bolt for Operating Lever	52	M4788	Rubber Pad for Clutch Pedal Top
24	M727	Locking Rivet for Lever Ball	53	M780A	Cotter Pin and Nut for Clutch Pedal
25	M2769	Cover for Change Speed Bracket	54	M787	Pull-off Spring
26	M2771	Tray for Change Speed Bracket	55	M789	Spring Anchor
27	M2722A	Change Speed Lock complete	56	M4789A	Adjusting Screw and Nut for Clutch Pedal

Please state maker's CAR NUMBER and CHASSIS NUMBER when ordering. See note on Page 3. Prices of Spare Parts are shown on separate list.

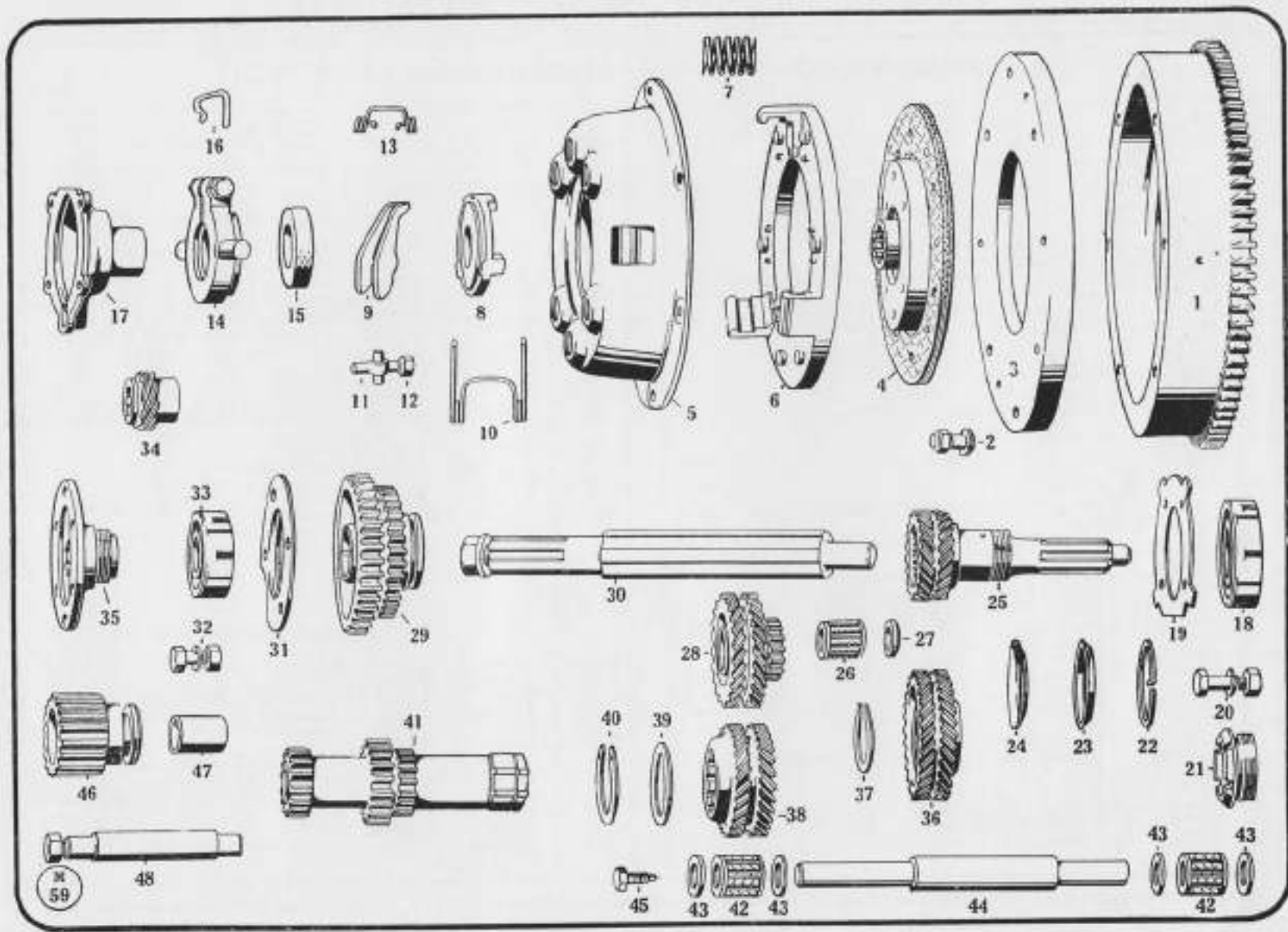

WOLSELEY "HORNET SPECIAL" SIX-CYLINDER

Clutch and Gearcase Gears

No. of Illustration.	Service No. for ordering.	Description of Part.	No. of Illustration.	Service No. for ordering.	Description of Part.
Flywheel and Clutch					
1	M4801—1	Flywheel with Starter Gear Ring Integral	26	M836	Spigot Roller Bearing for Mainshaft
2	M802A	Bolt and Nut for Flywheel	27	M837	Packing Washer for Spigot Bearing
3	M4803	Flywheel Cover	28	M2836	Third and Fourth Speed Sliding Gear
4	M4804A	Clutch Plate complete with Centre and Two Fabrics	29	M4837	First and Second Speed Sliding Gear
5	M4805	Clutch Cover	30	M2838A	Mainshaft with Nut and Washer
6	M4806	Clutch Pressure Plate	31	M2839	Bearing Retaining Plate
7	M4807	Clutch Spring	32	M2840A	Bolt, Nut and Washer for Bearing Retaining Plate
8	M4808	Clutch Release Lever Plate	33	M840	Ball Bearing for Mainshaft
9	M4809	Clutch Release Lever (set of 3) *	—	M2842—1	Speedometer Driving Gear
10	M4810	Clutch Release Lever Retaining Wire	35	M2843	Universal Flange on Mainshaft
11	M4811	Clutch Release Lever Pin and Eye Bolt (set of 3) *			
12	M4812	Nut for Eye Bolt			
13	M4813	Anti-Rattle Spring			
<i>Note: Items marked * are only supplied in sets of three.</i>					
Clutch Release Bearing					
14	M4814A	Release Bearing complete with Retainer	36	M4844	Constant Mesh Gear
15	M4815	Clutch Release Bearing (Graphite)	37	M4845	Spring Ring for Constant Mesh Gear
16	M4816	Release Bearing Retainer	38	M4846	Third Speed Constant Mesh Gear (Bushed)
17	M4817	Front Cover for Gearcase	—	M4847	Rollers for Third Speed Constant Mesh Gear (2½ per Set)
First Motion Shaft and Details			39	M4848	Washer for Rollers
18	M828	Ball Bearing for First Motion Shaft	40	M2849	Spring Ring for Third Speed Constant Mesh Gear
19	M2822	Retaining Plate for Ball Bearing [Retaining Plate	41	M4850	Layshaft Gear
20	M2823A	Bolt, Nut and Washer for Front Cover and Bearing	42	M856	Roller Bearing for Layshaft Gear
21	M825	Adjusting Nut for First Motion Shaft Bearing	43	M897	Washer for Layshaft Roller Bearing
22	M826	Locking Wire for Adjusting Nut	44	M4853	Layshaft
23	M827	Oil Thrower for First Motion Shaft	45	M854	Locking Screw for Layshaft
24	M830	Oil Thrower for First Motion Shaft	—	M4855A	Layshaft Gears assembled complete
25	M4831	First Motion Shaft			
			Reverse Shaft and Details		
			46	M2854A	Reverse Gear (Bushed)
			47	M2855	Bush for Reverse Gear
			48	M2856A	Reverse Shaft with Nut and Washer

Please state maker's CAR NUMBER and CHASSIS NUMBER when ordering. See note on Page 3. Prices of Spare Parts are shown on separate list.

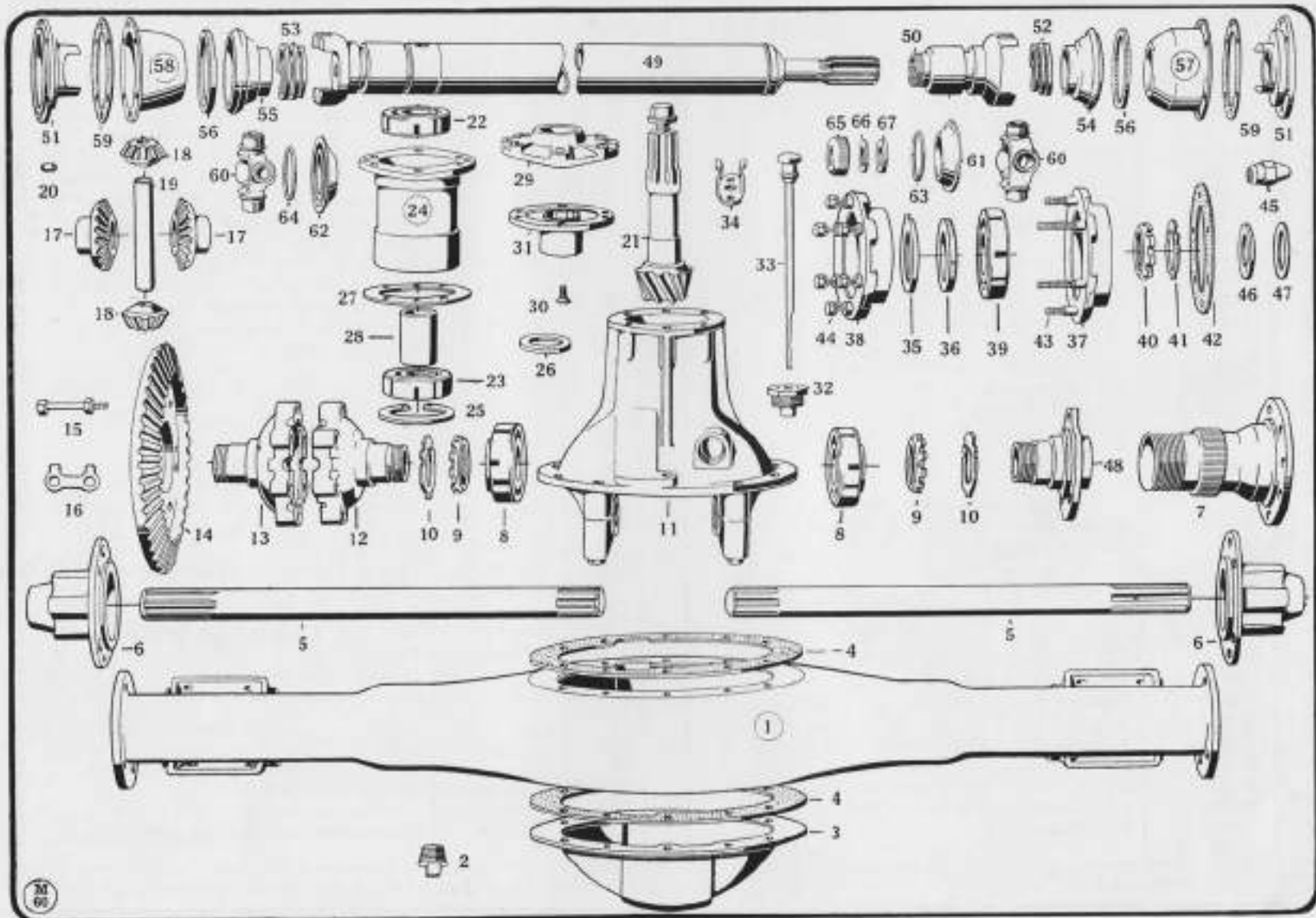

30

WOLSELEY "HORNET SPECIAL" SIX-CYLINDER

Rear Axle, Rear Hubs, Road Wheels and Propeller Shaft

No. of Illustration.	Service No. for ordering.	Description of Part.	No. of Illustration.	Service No. for ordering.	Description of Part.
Axle Case					
1	M5001A-1	Axle Banjo complete with Spring Seals	41	M940	Locking Washer for Bearing Nut
2	M904	Drain Plug for Axle Banjo	42	M947	Joint for Housing
3	M5003	Rear Cover for Axle Banjo	43	M949-1	Rear Wheel Stud (Bolt-on Wheel)
4	M5004	Joint for Cover (Front or Rear)	44	M949A	Rear Hub Stud (Centre Lock Road Wheel)
Differential Shafts					
5	M5010	Differential Shaft (Off-side or Near-side)	45	M940	Wheel Nut (Bolt-on Wheel)
6	M5011	Rear Hub (Bolt-on Wheel)	—	M270	Crosser for Rear Hub
7	M5012	Rear Hub (Off-side) (Centre Lock Road Wheel)	46	M5010	Oil Retainer Washer
—	M5013	Rear Hub (Near-side) (Centre Lock Road Wheel)	47	M5013	Oil Retaining Plate
Differential Cage and Bearings					
8	M5021	Ball Bearing for Differential Housing	48	M5012	Rear Hub Bearing Support (Off-side)
9	M944	Adjusting Nut See Differential Bearing	—	M5013	Rear Hub Bearing Support (Near-side)
10	M944	Lock Washer for Adjusting Nut	Propeller Shaft		
11	M5014A	Front Cover complete with Differential Bearing Caps (Less Dipstick and Filler Plug)	49	M2978A-1	Propeller Shaft with Fixed Yoke and Splined End
12	M5025	Differential Cage (Male)	50	M2979	Universal Joint Splined Yoke (Front)
13	M5026	Differential Cage (Female)	51	M2980	Flange Yoke (Front or Rear)
14	M5027	Crown Wheel (44 teeth)	52	M2981	Spring for Casing (Front)
15	M5028A	Bolt and Nut for Differential Cage and Crown Wheel	53	M2982	Spring for Casing (Rear)
16	M5035	Lock Washer for Differential Cage Bolt	54	M2983	Outer Casing for Joint (Front)
17	M5029	Differential Wheel	55	M2984	Outer Casing for Joint (Rear)
18	M5030	Differential Pinion	56	M2985	Packing for Casing (Front or Rear)
19	M5041	Pin for Differential Pinion	57	M2986	Inner Casing for Joint (Front)
20	M5032	Dowel for Pin	58	M2987	Inner Casing for Joint (Rear)
Bevel Pinion and Bearings					
21	M5041A	Bevel Pinion (9 teeth) with Nut and Washer	59	M2988	Gasket for Casing (Front or Rear)
22	M5042	Ball Bearing for Bevel Pinion	60	M2989A	Universal Joint Journal (Bushed) (Front or Rear)
23	M5043	Roller Bearing for Bevel Pinion	61	M2990	Baffle Cap (Front)
24	M5044	Housing for Bevel Pinion	62	M2991	Baffle Cap (Rear)
25	M5045	Spring Ring for Housing	63	M2992	Baffle Spring (Front)
26	M5046	Washer for Bevel Pinion	64	M2993	Baffle Spring (Rear)
27	M5047	Stem for Bevel Pinion Housing	65	M2994	Dust Cap
28	M5048	Distance Piece for Bevel Pinion Bearings	66	M2995	Steel Washer
29	M5049	Cap for Pinion Housing	67	M2996	Felt Washer
30	M939	Screw for Cap	—	M2998	Greaser (Front End)
31	M5064	Universal Flange on Bevel Pinion	—	M1013-E	Greaser (Rear End)
32	M5062	Filler Plug	—	M5096A-1	Propeller Shaft complete with Universal Flanges
33	M5063A	Oil Level Dipstick with Knob	Road Wheels		
34	M5064	Spring Retainer for Dipstick	—	M2991-E	Road Wheel (Bolt-on) (11" x 18" Rim) (27" x 4.75" Tyre)
—	M5065	Bolt for Differential Bearing Cap	—	M2993	Hub Cover for Road Wheel (Bolt-on Wheels)
Rear Hub Details					
35	M940-1	Washer for Oil Retaining Felt	—	M5096	Road Wheel (19" x 3" Rim) (Centre Lock Road Wheel)
36	M941-1	Oil Retaining Felt Washer	—	M2997	Lock Ring (Left Hand) (Centre Lock Road Wheel)
37	M2942A-2	Housing for Rear Hub Bearing complete with Wheel Studs (Bolt-on Wheel)	—	M2998	Lock Ring (Right Hand) (Centre Lock Road Wheel)
38	M2942A-3	Housing for Rear Hub Bearing complete with Studs (Centre Lock Road Wheel)	Sub-Assemblies		
39	M943-1	Ball Bearing for Rear Hub	—	M5081A	Front Cover complete with Crown Wheel, Pinion and Differential Gears, also Universal Flange
40	M944	Bearing Nut (Off-side)	—	M5082A	Front Cover complete with Pinion and Bearings and Universal Flange (Less Crown Wheel and Differential Gears)
—	M945	Bearing Nut (Near-side)	—	M5083A	Bevel Pinion Bearing Housing complete with Bearings and Cap
Propeller Shaft					
Road Wheels					
Sub-Assemblies					

Please state maker's CAR NUMBER and CHASSIS NUMBER when ordering. See note on Page 3. Prices of Spare Parts are shown on separate list.

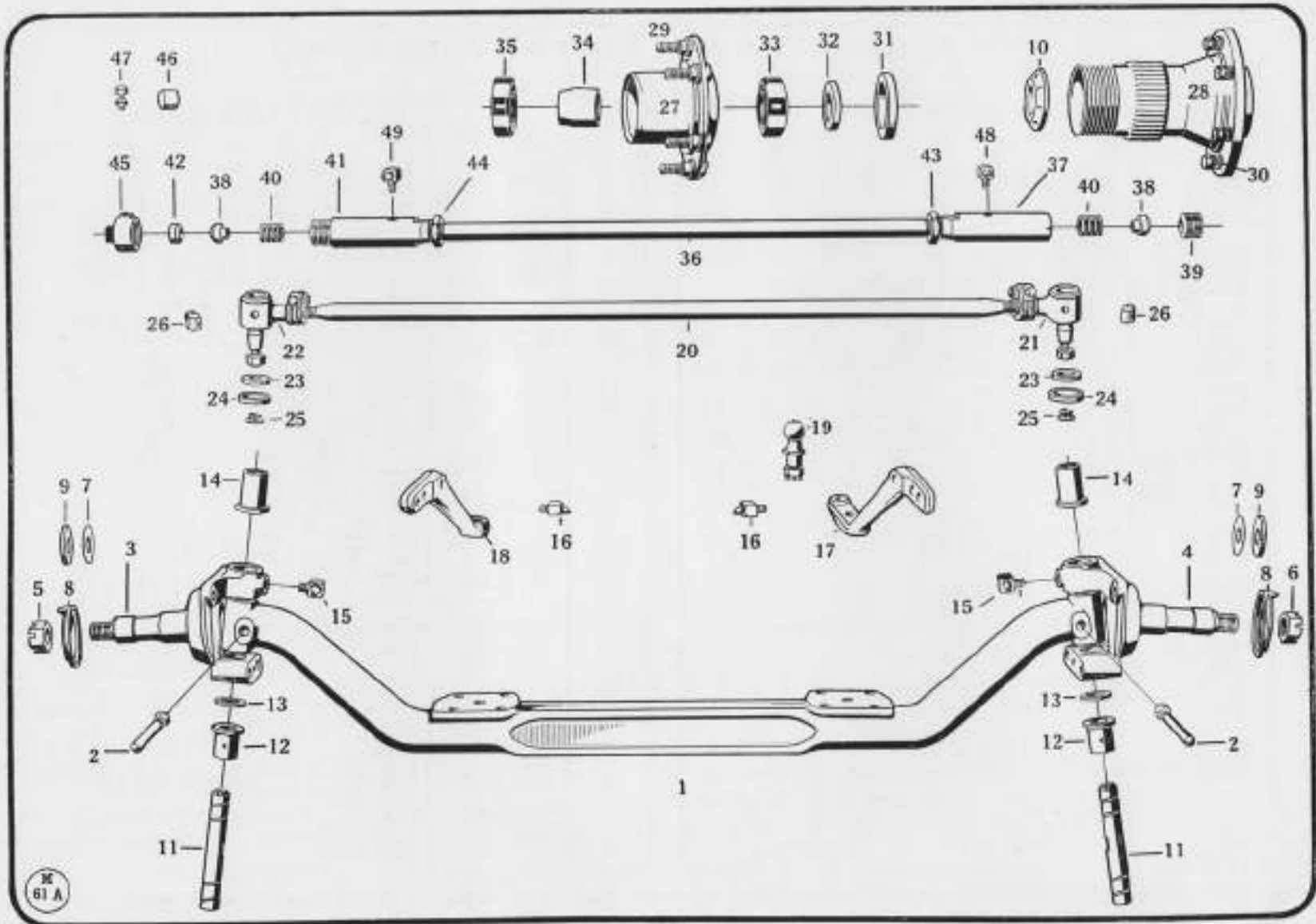

61 A

WOLSELEY "HORNET SPECIAL" SIX-CYLINDER

Front Axle, Front Hub and Steering Draglink

No. of Illustration	Service No. for ordering	Description of Part	No. of Illustration	Service No. for ordering	Description of Part			
Front Axle and Swivels								
1	M1001—1	Front Axle Beam	—	M3035A—2	Front Hub (Studded) (Near-side) (Centre Lock Road Wheel)			
2	M1002A	Cotter Pin, Nut and Washer for Swivel Pin	29	M1030—1	Wheel Stud (Bolt-on Wheel)			
—	M1026	Nut for Cotter Pin	30	M3036A	Hub Stud (Centre Lock Road Wheel)			
3	M1003A	Swivel Axle (Off-side) Bushed	31	M1037	Felt Washer			
4	M1004A	Swivel Axle (Near-side) Bushed	32	M1038	Distance Washer			
5	M1005	Nut for Swivel Axle (Off-side)	33	M1039	Ball Bearing for Front Hub (Inner)			
6	M1006	Nut for Swivel Axle (Near-side)	34	M1040	Distance Tube			
7	M1007—1	Washer for Swivel Arm	35	M1041	Ball Bearing for Front Hub (Outer)			
8	M1027	Grease Retainer for Front Hub	—	M1949	Wheel Nut (Bolt-on Wheel)			
9	M1028	Felt Washer for Grease Retainer	} Bolt-on Wheels					
10	M1007	Washer for Swivel Arm (Centre Lock Road Wheels)						
11	M1008	Swivel Pin	} Note:—For Road Wheels see Page 25.					
12	M1009	Bush for Swivel Axle (Bottom)						
13	M1010	Thrust Washer for Swivel Pin						
14	M1011A	Bush for Swivel Axle (Top)						
15	M1012	Greaser for Swivel Bush (Top)						
16	M1013—1	Greaser for Swivel Bush (Bottom)						
17	M1014—1	Track Rod Lever (Near-side)						
18	M1015—1	Track Rod Lever (Off-side)						
19	M1016A	Ball Pin and Nut for Track Rod Levers (Near-side) for Steering Draglink						
Track Rod								
20	M1022—1	Track Rod				36	M1051—1	Steering Draglink Tube
21	M1023A	End for Track Rod (R.H. thread) with Ball Pin				37	M1020	End for Draglink Tube (Near-side)
22	M1024A	End for Track Rod (L.H. thread) with Ball Pin				38	M1025	Ball Cap
23	M1025	Felt Washer				39	M1024	End Cap for Ball Joint (Near-side only)
24	M1026	Retainer for Felt Washer				40	M1025	Spring for Ball Joint
25	M1027	Spring				41	M1052	Sleeve for Drop Arm (Off-side)
26	M1012	Greaser for Ball Joint				42	M1053	Cup for Ball Joint (Off-side only)
Front Hub								
27	M3035A	Front Hub (Studded) (Bolt-on Wheel)				43	M1021	Lock Nut for End (R.H. thread)
28	M3035A—1	Front Hub (Studded) (Off-side) (Centre Lock Road Wheel)	44	M1022	Lock Nut for End (L.H. thread)			
Steering Draglink								
Sub-Assemblies								
Track Rod								
—	M1001A—1	Front Axle Beam assembled with Swivel Axles, Brake Anchor Plates, Steering Arms and Steering Track Rod	45	M1054	End Cap for Sleeve (Off-side)			
—	M1021A—1	Steering Track Rod complete	46	M1055	Distance Piece (Off-side)			
—	M3063A	Front Hub complete with Bearings and Wheel Studs (Bolt-on Wheels)	47	M1056A	Set Screw and Lock Nut for End Cap (Off-side)			
—	M3063A—1	Front Hub complete with Bearings and Studs (Off-side) (Centre Lock Road Wheels)	48	M1012	Greaser (Near-side)			
—	M3063A—2	Front Hub complete with Bearings and Studs (Near-side) (Centre Lock Road Wheels)	49	M1013—1	Greaser (Off-side)			
—	M3064A—1	Steering Draglink Tube complete						

Please state maker's CAR NUMBER and CHASSIS NUMBER when ordering. See note on Page 3. Prices of Spare Parts are shown on separate list.

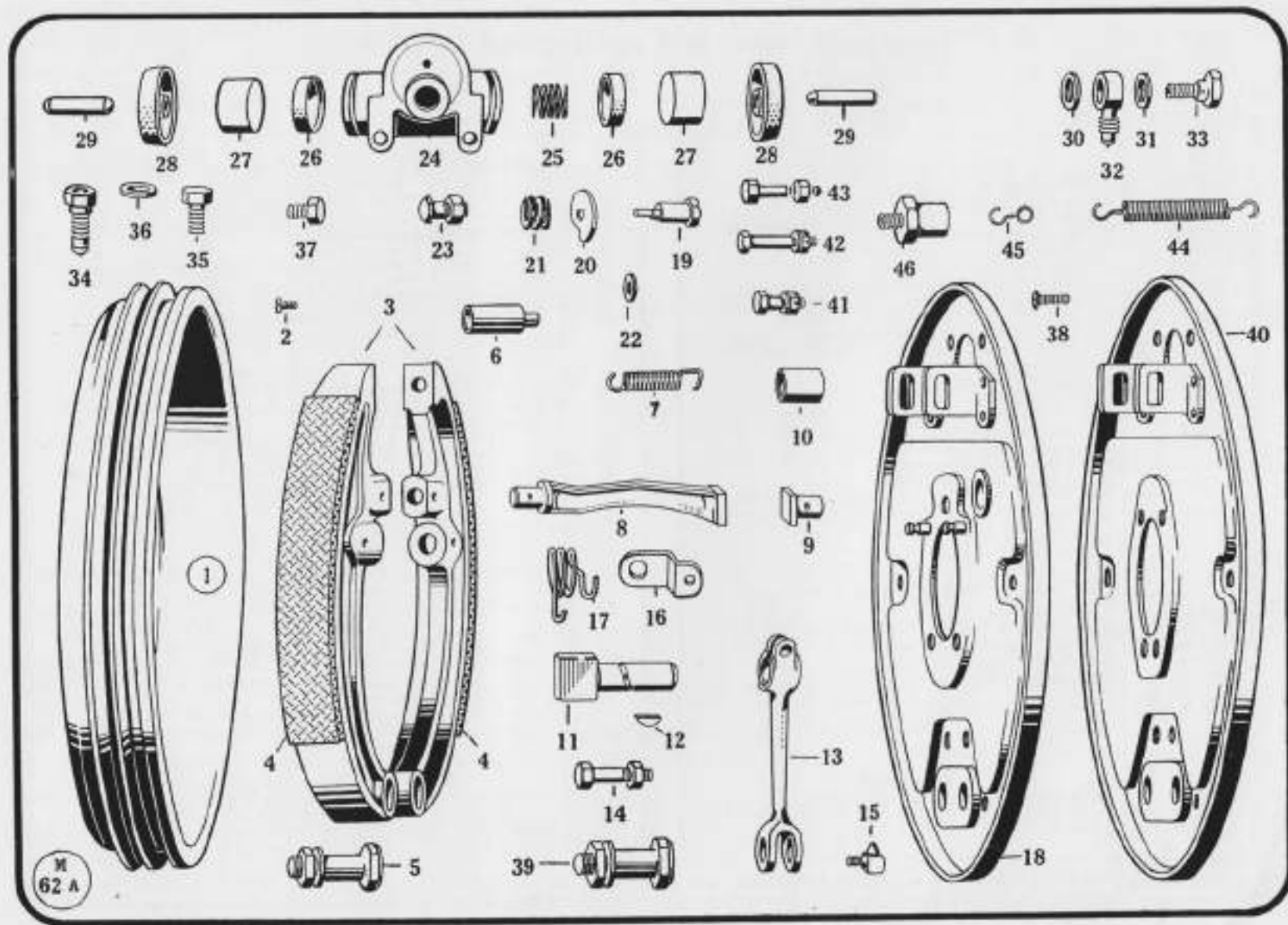

WOLSELEY "HORNET SPECIAL" SIX-CYLINDER

Brakes : Foot Brake (Lockheed Hydraulic) and Hand Brake

No. of Illustration.	Service No. for ordering.	Description of Part.	No. of Illustration.	Service No. for ordering.	Description of Part.
REAR WHEEL BRAKE (HAND AND FOOT)					
Brake-drums and Shoes					
1	M8101A-1	Brake-drum with Stiffening Band	—	M8141A-1	Sub-Assemblies Brake Anchor Plate complete with Shoes and Linings, Hand Brake Cam and Operating Lever, and Lockheed Wheel Cylinder (Off-side)
2	M1102	Screw for Brake-drum	—	M8142A-1	Brake Anchor Plate complete with Shoes and Linings, Hand Brake Cam and Operating Lever, and Lockheed Wheel Cylinder (Near-side)
3	M8103A	Brake-shoe complete with Lining (Pair)	—	M1144A	Lockheed Wheel Cylinder (less Inlet Connection)
4	M8104	Lining for Brake-shoe			
5	M8105A	Pivot Pin, Nut and Washer for Brake-shoes			
6	M8106	Socket for Brake-shoe			
7	M1107-1	Spring for Brake-shoes			
—	M1108	Peg in Shoe for Brake Spring			
Hand Brake Operating Mechanism					
8	M1109	Thrust Lever for Hand Brake Operating Cam	1	M8101A-1	Brake-drum with Stiffening Band
9	M1110	Thrust Pad for Hand Brake Operating Cam	28	M1152	Screw for Brake-drum
—	M8111	Peg for Thrust Lever or Pad	3	M8105A	Brake-shoe complete with Lining (Pair)
10	M1112	Bush for Cam Spindle Bearing	4	M8104	Lining for Brake-shoe
11	M1114	Operating Cam for Hand Brake	39	M8105A-1	Pivot Pin, Nut and Washer for Brake-shoes
12	F729	Key for Operating Lever	6	M8106	Socket for Brake-shoe
13	M8115A	Operating Lever for Hand Brake with Pinch Bolt, Nut and Washer (Off-side)	48	M1157	Spring for Brake-shoes
—	M8116A	Operating Lever for Hand Brake with Pinch Bolt, Nut and Washer (Near-side)	45	M1158	Link for Spring
14	M1117A	Pinch Bolt, Nut and Washer for Operating Lever	49	M8154A	Brake Anchor Plates Brake Anchor Plate assembled with Pivot Pin Anchor Plate (Off-side or Near-side)
15	M1012	Greaser for Hand Brake Cam	19	M1121	Bolt for Adjusting Cam
16	M8119	Spring Anchor for Hand Brake Pull-off Spring	20	M1122	Cam for Adjusting Brake-shoes
17	M8120	Pull-off Spring for Hand Brake (Off-side)	21	M1123	Spring for Adjusting Cam
—	M8121	Pull-off Spring for Hand Brake (Near-side)	22	M8125	Washer for Adjusting Cam Bolt (Small)
—	M8110A	Brake Anchor Plates Brake Anchor Plate (Off-side) complete with Cam Spindle Bearing, Pivot Pin Anchor and Spring Anchor Pins	41	M8154A	Brake Anchor Plate Bolt (Short) with Nut and Washer
18	M8120A	Brake Anchor Plate (Near-side) complete with Cam Spindle Bearing, Pivot Pin Anchor and Spring Anchor Pins	42	M8155A	Brake Anchor Plate Bolt (Long) with Nut and Washer*
19	M1121	Bolt for Foot Brake Adjusting Cam	43	M8156A	Brake Anchor Plate Bolt (Intermediate) with Nut and Washer*
20	M1122	Cam for Adjusting Brake-shoes			
21	M1123	Spring for Adjusting Cam			
22	M1125	Washer for Adjusting Cam Bolt			
23	M8126A	Bolt and Nut for Brake Anchor Plate			
Lockheed Wheel Cylinder					
24	M1131	Wheel Cylinder	34	M1131	Wheel Cylinder
25	M1132	Spring	25	M1132	Spring
26	M1133	Cup	26	M1133	Cup
27	M1134	Piston	27	M1134	Piston
28	M1135	Boot	28	M1135	Boot
29	M1136	Push Rod	29	M1136	Push Rod
30	G1986	Gasket for Inlet Connection (Inner)	30	G1986	Inlet Connection
31	G1987	Gasket for Inlet Connection (Outer)	31	G1987	Gasket for Inlet Connection
32	G1988	Inlet Connection	32	G1988	Inlet Connection
33	G1989	Bolt for Inlet Connection	33	G1989	Bolt for Inlet Connection
34	G1990	Bleeder Screw	34	G1990	Bleeder Screw
35	G1991	Set Screw for Bleeder Screw	35	G1991	Set Screw for Bleeder Screw
36	G1992	Spring Washer	36	G1992	Spring Washer
37	G1993	Set Screw for fixing Wheel Cylinder	37	G1993	Set Screw for fixing Wheel Cylinder
Lockheed Wheel Cylinder					
—	M116A	Sub-Assemblies Brake Anchor Plate complete with Brake-shoes and Linings, and Lockheed Wheel Cylinder (Off-side or Near-side)	—	M116A	Brake Anchor Plate complete with Brake-shoes and Linings, and Lockheed Wheel Cylinder (Off-side or Near-side)
—	M1144A	Lockheed Wheel Cylinder complete (less Inlet Connection)	—	M1144A	Lockheed Wheel Cylinder complete (less Inlet Connection)

Please state maker's CAR NUMBER and CHASSIS NUMBER when ordering. See note on Page 3. Prices of Spare Parts are shown on separate list.

free download from PVEIKL.com

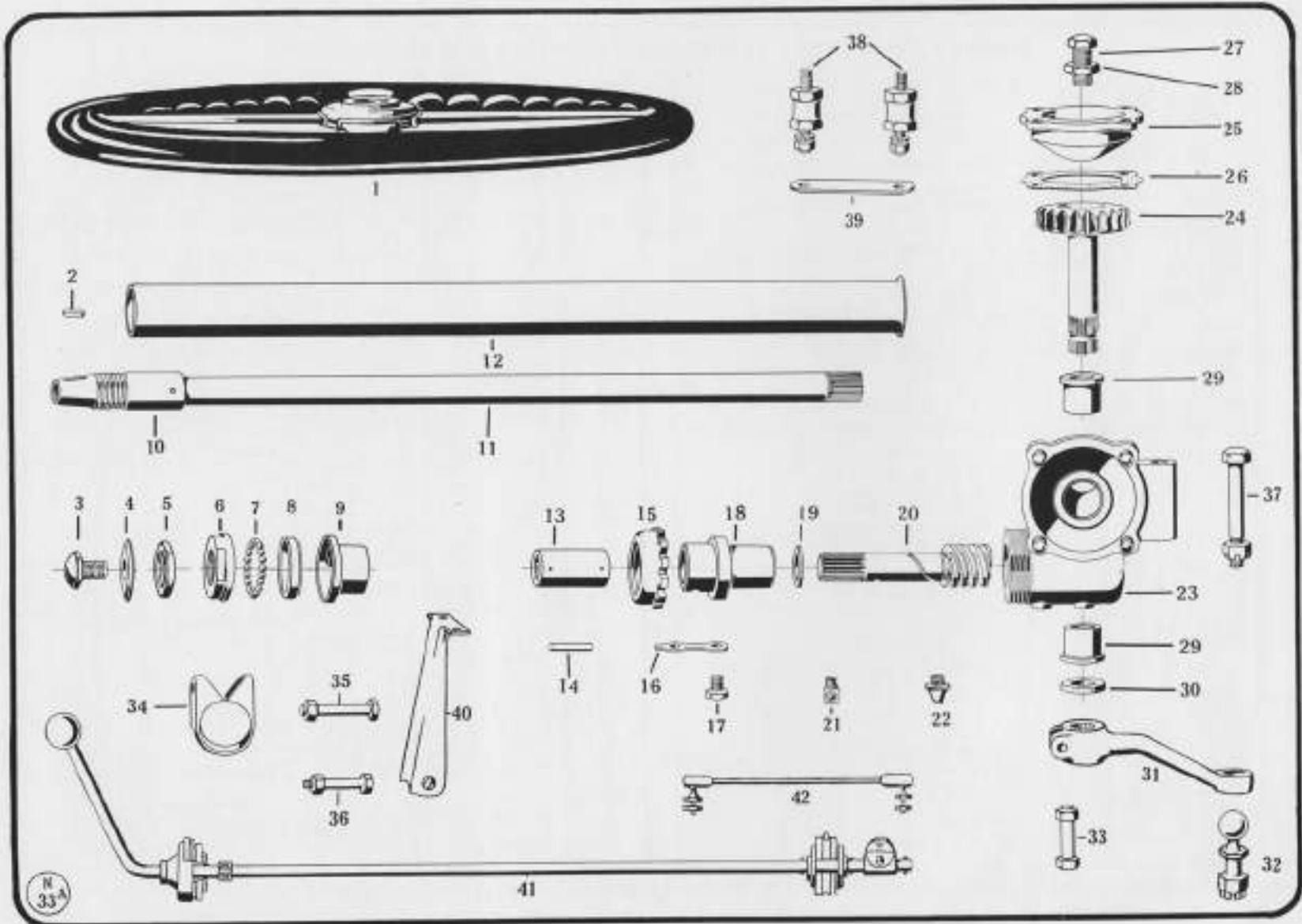

N
35A

WOLSELEY "HORNET SPECIAL" SIX-CYLINDER

Control—Steering and Ignition

No. of Illustration.	Service No. for ordering.	Description of Part.	No. of Illustration.	Service No. for ordering.	Description of Part.
Steering Wheel and Column					
1	M1201	Steering Wheel	23	M1223A—1	Steering Box (Bushed and Studded)
2	M1202	Key for Steering Wheel	24	M1224	Steering Worm Wheel
3	M1203—1	Set Screw for Steering Wheel	25	M1225	Cover for Steering Box
4	M1204—1	Washer for Steering Wheel Set Screw	26	M1226	Joint for Steering Box Cover
5	M1205—1	Lock Nut for Steering Ball Race	—	M1227A	Thrust Screw and Lock Nut for Worm Wheel
6	M1206—1	Upper Ball Race for Steering	27	M1228	Thrust Screw
7	M1207	Steel Balls for Ball Race ($\frac{3}{16}$ in. dia.) 24 per set	28	M1229	Lock Nut for Thrust Screw
8	M1208	Lower Ball Race for Steering	29	M1230	Bush for Steering Worm Wheel (two of these are fitted)
9	M1209—1	Housing for Ball Race	30	M1231	Felt Washer
10	M1210	Plug for Steering Column	31	M1232A—3	Steering Drop Arm with Ball Pin and Pinching Bolt
11	M3211—1	Steering Column Tube	32	M1016A	Ball Pin and Nut for Steering Drop Arm
12	M3212—3	Outer Tube for Steering Column	33	M1234A—1	Pinch Bolt and Nut for Drop Arm
13	M1213	Coupling Piece for Steering Column	Steering Details		
14	M1214	Rivet for Coupling Piece	34	M1235—1	Clamp for Steering Column (Top or Centre)
15	M1215	Steering Box Nut	35	M1236A	Swivel Bolt for Clamp, Nut and Washer (Centre only)
16	M1216	Locking Piece for Nut	36	M1242A	Clamp Bolt, Nut and Washer for Steady Bracket
17	M1217	Set Screw for Lock Piece	37	M1237A—1	Bolt, Nut and Split Pin (Steering Box to Support Bracket)
18	M1218	Bush for Steering Worm Shaft	38	M1238A—1	Steering Stop Stud with Nut and Washer
19	M1219	Thrust Washer for Steering Worm	39	M1239	Steering Stop Stud Plate
20	M1220	Steering Worm	40	M3241—4	Steady Bracket for Steering Column
Steering Box and Worm Wheel					
21	M1012	Greaser for Steering Box	41	M3251—1	Ignition Control complete
22	M279	Greaser for Steering Worm Bush	42	M3252A—1	Ignition Control Link
Ignition Control					

Please state maker's CAR NUMBER and CHASSIS NUMBER when ordering. See note on Page 3. Prices of Spare Parts are shown on separate list.

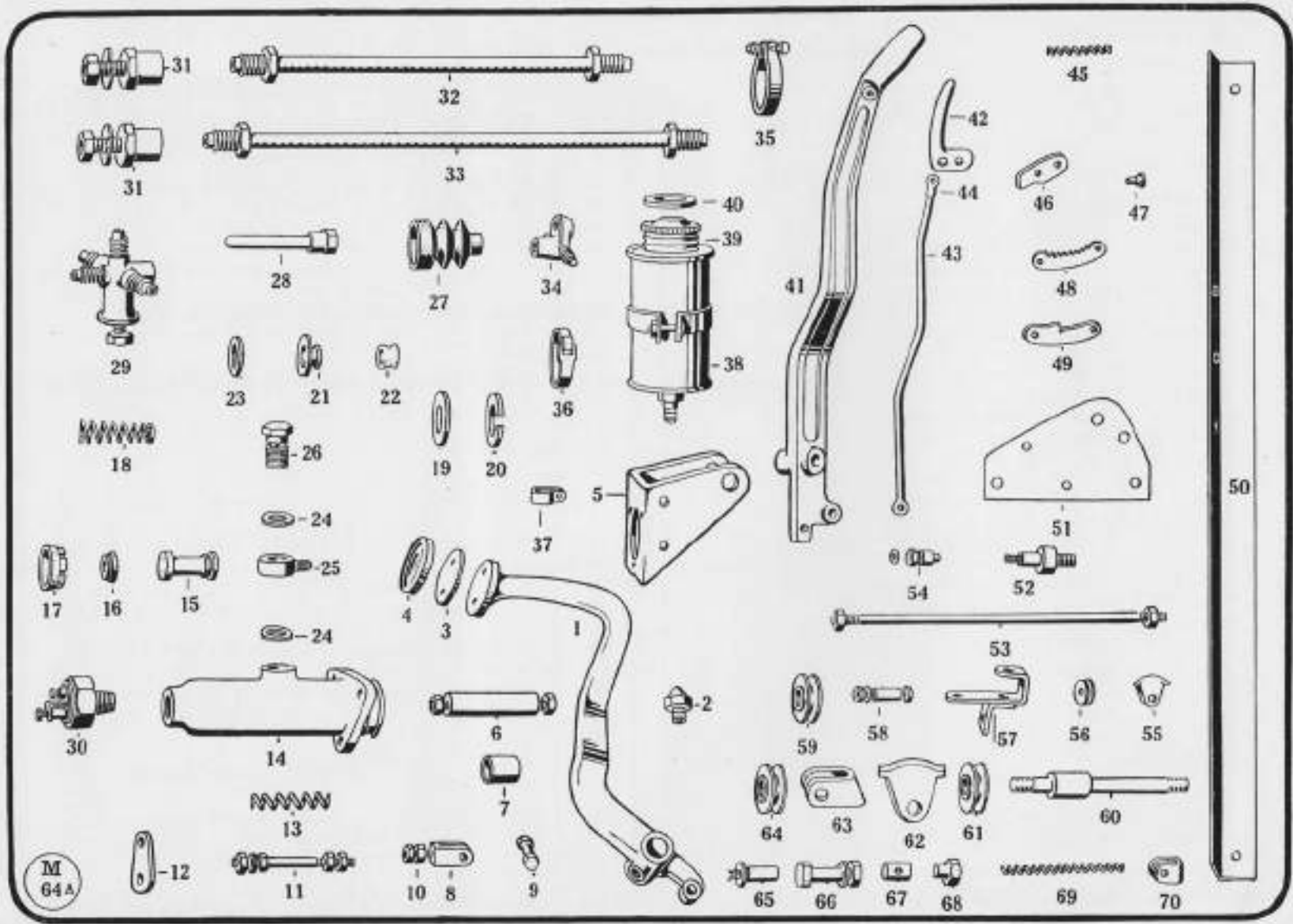

M
64A

WOLSELEY "HORNET SPECIAL" SIX-CYLINDER

Brake Control (Hand and Foot Brakes)

No. of Illustration.	Service No. for ordering.	Description of Part.	No. of Illustration.	Service No. for ordering.	Description of Part.
Brake Pedal					
1	M1891-1	Brake Pedal	28	M3361A	Supply Tank complete with Fixing Brackets
2	M279	Greaser for Pedal	39	M1472A	Cap for Supply Tank complete with Baffles
3	M4784	Brake Pedal Top	40	M1473	Rubber Washer for Filler Cap
4	M4788	Rubber Pad for Brake Pedal	—	M3364A	Supply Pipe from Tank to Master Cylinder
5	M5303	Bracket for Pedal and Lockheed Master Cylinder			
6	M2305A	Pin for Brake Pedal with Nuts and Washers			
7	M2306	Distance Piece for Brake Pedal Pin			
8	M5306A	Eye Piece for Master Cylinder with Bolt, Nut and Lock Nut			
9	M5307A	Bolt and Nut for Eye Piece			
10	M1808	Lock Nut for Eye Piece			
11	M1379A	Stud for Master Cylinder and Brake Stop with Nuts and Washer			
12	M1810	Brake Stop Piece			
13	M1311	Push-off Spring for Brake Pedal			
Lockheed Master Cylinder					
14	M1321	Master Cylinder	41	M2293-1	Hand Brake Lever
15	M1323	Piston for Master Cylinder	42	M253	Grasp Lever
16	M1324	Secondary Cup for Master Cylinder	45	M2264A	Fixed Rod with Eye Piece
17	M1325	Cup for Master Cylinder	44	M755	Eye Piece for Pawl Rod (Top)
18	M1325A	Retain Spring for Master Cylinder with Retainer	45	F1005	Spring for Pawl Rod
19	M1329	Piston Stop	40	M757	Brake Pawl
20	M1330	Spring Retainer for Stop	47	M758	Pin for Brake Pawl
21	M5328	Valve Body	48	M759	Brake Quadrant
22	M5327	Valve Cup	49	M760	Stop for Hand Brake
23	M5328	Valve Washer	30	M1378-1	Supporting Angle for Hand Brake
24	V1430	Gasket for Inlet Connection Banjo	31	M1379	Plate for Hand Brake Fulcrum
25	V1434	Banjo Connection (Inlet)	52	M1380A	Fulcrum Pin, Nuts and Washers
26	V1 35	Banjo Connection Fixing Bolt	53	M1380A	Support Rod for Hand Brake with Nuts
27	M1340	Beet for Master Cylinder	54	M765A	Pin, Nut and Washer for Pulley on Hand Brake Lever
28	M1341A	Pawl Rod assembled with Cup	55	M765	Shaft for Pulley
—	M3346A	Master Cylinder complete	56	M764	Pulley on Hand Brake Lever
Lockheed Pipe Line					
—	M5345A	Pipe from Master Cylinder to 4-Way Piece complete with Nuts	57	M1381A-1	Cable Pulley Bracket on Cross Member
29	M5346	4-Way Piece mounted on Cross Member	58	M1382A-1	Pulley Spindle for Bracket with Nuts and Washers
30	V4400	Switch for Stop Light	59	M1383-1	Pulley for Bracket
—	M5347A-1	Pipe to Near-side Front Wheel complete with Nuts	60	M1383A-1	Bolt in Cross Member for Intermediate Pulley, with Nut, Washer and Collar
—	M5348A-1	Pipe to Off-side Front Wheel complete with Nuts	61	M1385-1	Intermediate Pulley
31	GD1237A	Hose Connection complete with Nut and Washer	62	M765-1	Sheath for Intermediate Pulley
32	GD1237A	Flexible Hose complete (Front Wheels only)	63	M1385-2	Yoke for Brake Cable Pulley
—	M5349	Pipe from 4-Way Piece to Rear Hose complete with Nuts	64	M1386-1	Pulley for Yoke
—	M5350A-1	Pipe to Near-side Rear Wheel complete with Nuts	65	M1393A	Pin, Washer and Split Pin for Pulley in Yoke
—	M5351A-1	Pipe to Off-side Rear Wheel complete with Nuts	66	M1394A	Bolt, Nut and Washer for Yoke to Spring Bracket
33	GD1247A	Hose Connection complete with Nut and Washer	66	M1388-3	Brake Cable
34	V4452	Flexible Hose complete (Rear only)	67	M1389	Rocking Pin in Axle Operating Lever
35	GD1244	Hose Bracket on Axle Tube	68	M1390	Adjusting Nut for Brake Cable
36	M1368A	Clip for Hose Bracket	69	M1391	Spring for Adjusting Nut
37	GD1247	Clip for Pipe to Rear Axle	70	M1392A	Cap for Brake Cable with Bolt and Nut
37	M1376	Pipe Clip for Axle Case (Centre)			
Lockheed Supply Tank					
Hand Brake Control					
Hand Brake Lever and Support					
Brake Cables and Pulleys					

Please state maker's CAR NUMBER and CHASSIS NUMBER when ordering. See note on Page 3. Prices of Spare Parts are shown on separate list.

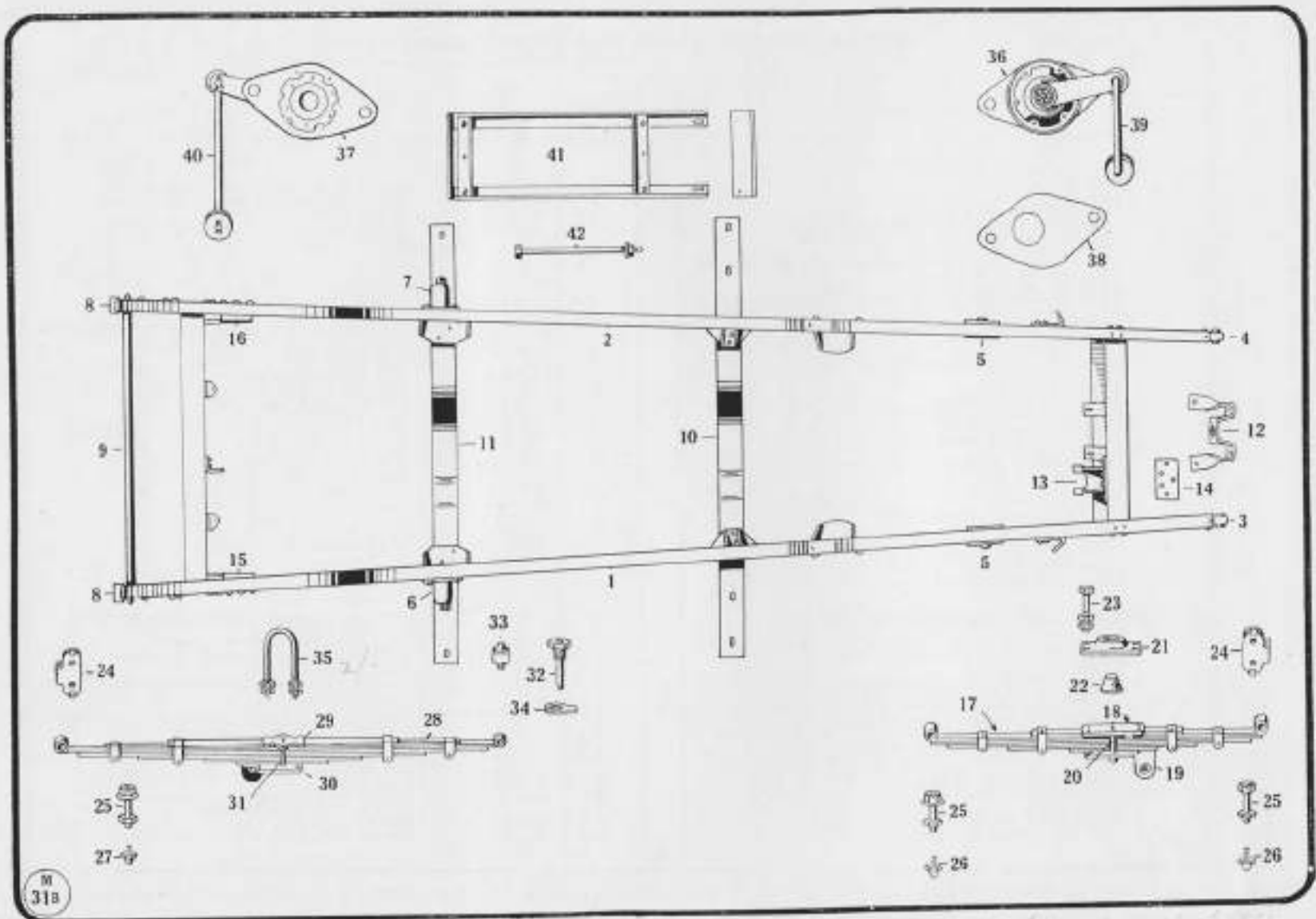

12 leaf rear axle for with clips

19. leaf with clips

*M5437-2 2 1/2-8
 12 leaf to 17 1/2 cut. clip M5445A-2. 2/each*

WOLSELEY "HORNET SPECIAL" SIX-CYLINDER

Frame Fittings and Spring Suspension

No. of Illustration.	Service No. for ordering.	Description of Part.	No. of Illustration.	Service No. for ordering.	Description of Part.
Frame					
1	M3402-2	Frame Side Member (Off-side)	—	M5438A-1	Rear Road Spring complete (Near-side)
2	M3403-3	Frame Side Member (Near-side)	29	M5439A-1	Top Securing Plate for Rear Spring (dowelled)
3	M1404	Front Spring Front Support (Off-side)	30	M5440A-1	<i>Note:—Separate Spring Plates can be supplied to order.</i> Bottom Plate and Shock Absorber Bracket (Off-side) for Rear Road Spring
4	M1405	Front Spring Front Support (Near-side)	—	M5441A-1	Bottom Plate and Shock Absorber Bracket (Near-side) for Rear Road Spring
5	M1406	Front Spring Rear Support	31	M5442-1	Screw for Rear Spring Plates
6	M1407-1	Rear Spring Front Support (Off-side)	32	M1406	Rear Spring Front Pin
7	M1408-1	Rear Spring Front Support (Near-side)	33	M1013-1	Greaser for Rear Spring Front Pin
8	M1409	Rear Spring Rear Support	34	M1408-1	Lock Washer for Rear Spring Front Pin
9	M1410A	Rear Cross Tube complete with Nuts and Washers	35	M5445A-1	Spring Clip and Nuts for Rear Spring
10	M1411	Frame Cross Member and Running-board Support (Front)			
11	M3412-1	Frame Cross Member and Running-board Support (Rear)			
12	M1413-2	Steering Handle Bracket			
13	M3410-1	Support Bracket for Steering Box			
14	M1415	Stiffening Piece for Steering Box Support			
15	M3447	Shock Absorber Bracket (Rear Off-side)	36	M3442	Shock Absorber and Fittings Shock Absorber (Front Off-side)
16	M3448	Shock Absorber Bracket (Rear Near-side)	—	M3443	Shock Absorber (Front Near-side)
			37	M3445	Shock Absorber (Rear Off-side)
			—	M3446	Shock Absorber (Rear Near-side)
			39	M3444	Connecting Link for Front Shock Absorber
			40	M3447	Connecting Link for Rear Shock Absorber
			—	M1632-1	Rear Number-plate
			—	M1631	Front Number-plate
Road Springs and Suspension					
17	M5421A-1	Front Road Spring complete (Off-side)			
—	M5422A-1	Front Road Spring complete (Near-side)			
18	M5423-1	Top Securing Plate for Front Spring			
19	M5424A-1	Bottom Plate and Shock Absorber Bracket (Off-side) for Front Spring (dowelled)			
—	M5425A-1	Bottom Plate and Shock Absorber Bracket (Near-side) for Front Spring (dowelled)			
20	M1423	Screw for Front Spring Plates			
21	M5427-1	Front Spring Buffer Plate	41	M1463A	Battery Carrier and Details Battery Carrier complete
22	M1425	Rubber Buffer for Front Spring	42	H1110A	Clamp Bolt and Nut for Battery
23	M5428A-1	Holding-down Bolt and Nuts for Front Spring			
24	M1427-1	Shackle for Road Springs (Front or Rear)			
25	M1428A	Pin for Front Spring (Front or Rear) or Rear Spring (Rear) complete with Nut and Washers			
26	M279	Greaser for Front Spring Pins			
27	M1612	Greaser for Rear Spring Shackle Pins			
28	M5437A-1	Rear Road Spring complete (Off-side)	—	M3471A-4	Sub-Assemblies Frame complete with Spring Brackets and Cross Members

Please state maker's CAR NUMBER and CHASSIS NUMBER when ordering. See note on Page 3. Prices of Spare Parts are shown on separate list.

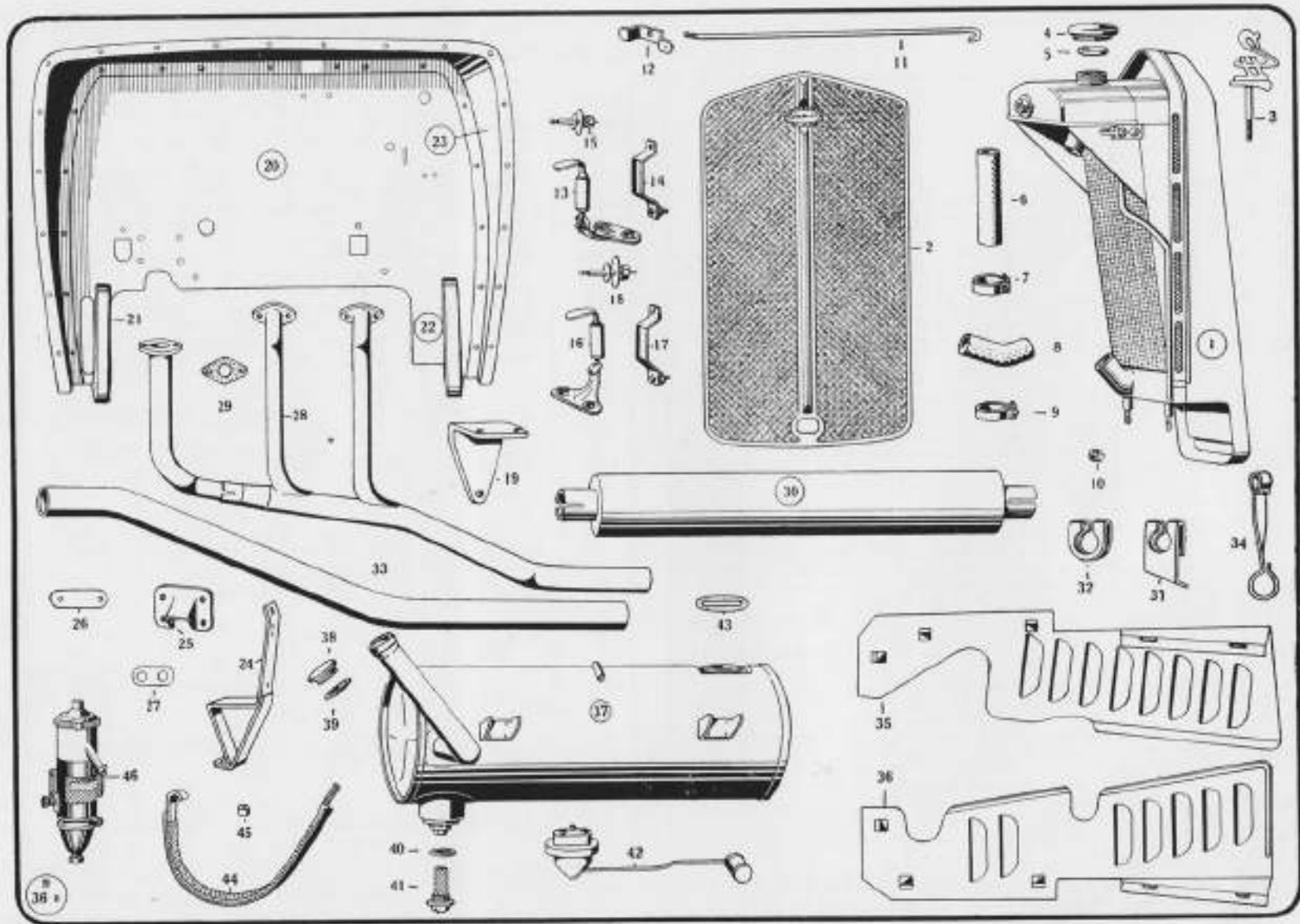

WOLSELEY "HORNET SPECIAL" SIX-CYLINDER

Radiator, Bonnet, Exhaust Pipes, Petrol Tank, etc.

No. of Illustration.	Service No. for ordering.	Description of Part.	No. of Illustration.	Service No. for ordering.	Description of Part.
Radiator and Details			Silencer and Exhaust Pipes		
1	M3501A—3	Radiator complete with Stone Guard	28	M3535A—2	Exhaust Pipe (Engine to Silencer)
2	M3502—2	Stone Guard for Radiator	29	M1543—1	Joint for Exhaust Pipe Flange
—	M3503—1	Shell for Radiator	30	M1545—1	Silencer complete
3	M3504A	Miscot for Radiator	31	M3539A	Clip for Silencer (Front End)
4	M3505	Filler Cap for Radiator	32	M3537A	Support Bracket for Silencer (Rear)
5	M3506	Rubber Washer for Filler Cap	33	M3538—1	Rear Exhaust Pipe
6	M3508—1	Rubber Hose (Top)	34	M3541A—1	Support Clip for Exhaust Pipe (Rear)
7	M3509	Clip for Top Rubber Hose			
8	M3510—1	Rubber Hose (Bottom)			
9	M3511	Clip for Bottom Rubber Hose			
10	M1513	Rubber Packing for Radiator Mounting			
11	M3514A—1	Radiator Tie Rod complete	35	M3542—2	Undershield (Off-side)
12	M1515—1	Dashboard Bracket for Tie Rod (Off-side)	36	M3543—2	Undershield (Near-side)
—	M1515—2	Dashboard Bracket for Tie Rod (Near-side)	—	M1552—1	Bracket for Shield (Off-side)
			—	M1552—2	Bracket for Shield (Near-side)
			—	M1553	Clip for Undershield
Bonnet and Details			Undershields		
13	M1519—1	Front Bonnet Catch			
14	M1520A	Bonnet Handle and Tension Bracket (Front)			
15	M1521A	Pin for Bonnet Catch (Front)			
16	M1523—1	Rear Bonnet Catch	37	M3547A—1	Petrol Tank complete
17	M1524A	Bonnet Handle and Tension Bracket (Rear)	38	H1222—1	Cap for Filler
18	M1517A	Pin for Bonnet Catch (Rear)	39	M3549	Leather Washer for Cap
19	M1525—1	Support Bracket for Rear Bonnet Catch	40	G1463A	Cap for Tank Sump with Strainer Gauze
			41	GDI461	Washer for Sump Cap
			42	M3552	Petrol Gauge (Tank Unit)
			43	M3553	Joint for Petrol Gauge
			44	M3554A	Strap for Petrol Tank complete
			45	M3555	Rubber Packing Ring for Strap End
			46	M3556—1	S.U. Petrolift complete
			—	M3559A—1	Petrol Pipe (Main Feed from Tank) complete with Nuts
			—	M3561	Union for Main Feed Pipes
			—	M3560A—3	Petrol Pipe (short) to Petrolift
			—	M3559A—1	Petrol Pipe (Petrolift to Carburettor)
Dashboard and Details			Petrol Tank and Petrol Pipes		
20	M3526—4	Dashboard			
21	M3527A	Support Bracket for Dashboard (Off-side)			
22	M3528A	Support Bracket for Dashboard (Near-side)			
23	M3529A—2	Dash Shroud			
24	M3534—1	Toeboard Support			
25	M3533	Steering Column Support Bracket (Engine Side)			
26	M1541	Lock Plate for Steering Support Bracket Bolts (Driving Side)			
27	M3540	Link for Steering Column			

Please state maker's CAR NUMBER and CHASSIS NUMBER when ordering. See note on Page 3. Prices of Spare Parts are shown on separate list.

WOLSELEY "HORNET SPECIAL" SIX-CYLINDER

Tools, etc.

Service No. for ordering	Description of Part.	
M3721	Tyre Pump	
M3722	Lifting Jack complete with Folding Handle	
M3723	Adjustable Spanner	
M3724	Box Spanner ($\frac{1}{2}$ " and 1")	
M3725	Box Spanner (1" and $\frac{1}{2}$ ")	
M3726	Box Spanner ($\frac{3}{4}$ " and $\frac{1}{2}$ ")	
M3727	Double-ended Spanner (1" and $\frac{1}{2}$ ")	
M3728	Double-ended Spanner ($\frac{1}{2}$ " and 1")	
M3729	Double-ended Spanner ($\frac{1}{2}$ " and 1")	
M3730	Tappet Spanner	
M3731	Feeler Gauge	
M3732	Crowfoot Spanner (Cylinder Head Nuts)	
M3733	Box Spanner (Sparking Plugs)	
M3738	Wheel Brace (for Bolt-on Road Wheels)	
M3738	Lead Hammer (for Centre Lock Road Wheels)	
M3739	Tommy Bar	
M3714	Grease Pump	
M3716A-1	Starting Handle	
GD1003	Bleeder Wrench	
GD1004	Drain for Bleeder Screw	for Lockheed Brakes
GD1005	Drain Tube	

Please state maker's CAR NUMBER when ordering. See note on Page 3. Prices of Spare Parts are shown on separate list.

Maker's Car No.....

This is the No. to be quoted
in all correspondence or when
ordering replacements.

Type of Car.....

Owner :

.....

.....

.....

Car Registration No.....

Licence No.....

Date Renewal Due.....

PRINTED IN GREAT BRITAIN BY
THE MORRIS-STURTON PRESS LTD.
LONDON E.C. 4. 647066

No. 978 11719-00/31211

PRICE LIST
for
SPARE PARTS

1932

The
"Hornet Special"
SIX-CYLINDER



This Price List has been compiled for use with Illustrated Spare Parts List No. 914.

The prices are grouped under page numbers, and the service numbers are arranged in alphabetical and numerical order in each group.

The prices are "free at Works" and are subject to alteration without notice.

To avoid delay, customers with whom we have no ledger account should send cash with order or state C.O.D.

WOLSELEY MOTORS (1927) LTD.

WARD END,
BIRMINGHAM

The Wolseley "Hornet Special" Six-Cylinder Model

Service No. for ordering.	Price Each. £ s. d.	Service No. for ordering.	Price Each. £ s. d.	Service No. for ordering.	Price Each. £ s. d.
Crankcase, Oilbase and Engine Support Details. Spare Parts List, Page 5.			Cylinder Head, Camshaft, Valves, etc. Spare Parts List, Page 9.		
E200 doz.	0	M104	6	F229 doz.	1 7
G58	1 0	M105	4	G135	0
M7	11	M117	2 4	M205A	2 2
M8A	1 8	M118	19 6	M206A	2 2
M9-1	0	M119	8 9	M209A	11 6
M10 doz.	1 9	M120 doz.	1 4	M210A	2 6
M12	10	M121-1	0 0	M211	1 8
M16	1 0	M122 doz.	1 2	M212 doz.	1 3
M18A	4	M123A	1 2 0	M213 doz.	1 0
M19-1 doz.	2 3	M126A	1 2 0	M214 doz.	6
M27	3	M129A	4 9	M215A	5 0
M42	3	M130 doz.	11	M216A	5 0
M45	2 9	M131A	4	M217 doz.	2 3
M51A	8	M133 doz.	8	M218 doz.	2 0
M52	3	M135A	15 0	M219 doz.	2 2
M53A	6	M136A	15 0	M220 doz.	2 0
M54	3	M147	10	M222	3-4
M55	1 3	M148	10	M223	4-6
M56	3	M150	11	M224 doz.	9
M492 doz.	2 0	M151	11	M225 doz.	2 3
M1511-1	1 0	M153	1 3	M226	2 0
M2001A-1	11 17 0	M154A	18 11	M227	3
M2002A-1	11 17 0	M155	3	M228-1	4
M2008A-1	12 9	M156-1	4	M229 doz.	1 0
M2009	1 0	M157 doz.	2 0	M230	6
M2011A-1	0 0	M158A	5 3	M231-1	1 6
M2015A-1	2 5 4	M160-2	1 1	M234 doz.	1 5
M2020A	9 0	M161-1 doz.	1 0	M235 doz.	6
M2021	3	M162 doz.	1 0	M239A	2 1
M2022	11	M163-1	1	M242A	1 10
M2023	3	M174A	1 7	M245A-1	1 10
M2024A	11 9	M865	8	M247	2 0
M2025	2	M2101A	4 10 4	M248-1	1 2
M2026	3	M2106	6 3	M249 doz.	3
M2031A	18 4	M2107	6 0	M250 doz.	4
Crankshaft and Bearings, Connecting Rod and Piston. Spare Parts List, Page 7.			M253		
M102	1 10	M2128 doz.	11	M258A	18 8
M103	3	M2132	1 3	M281A	6 0
		M2141A-1	9 5	M2201A-1	6 15 0
		M2142A-1	9 5	M2202	3 9
		M2144-1	6 10	M2203A	14 8
		M2145-1	6 10	M2203A-1	14 8
		M2171A-1	1 7 11	M2206	3 0
		M2172A-1	1 7 11		

WOLSELEY "HORNET SPECIAL" SIX-CYLINDER MODEL

Service No. for ordering.	Price Each. £ s. d.	Service No. for ordering.	Price Each. £ s. d.	Service No. for ordering.	Price Each. £ s. d.
M1225...	8 4	M1378-1	2 8	Frame Fittings and Spring Suspension Spare Parts List, Page 33. H1110A 6 M279 doz. 2 0 M1012... .. 5 M1013-1 5 M1404... .. 7 8 M1405... .. 7 8 M1406... .. 3 11 M1407-1 10 6 M1408-1 10 6 M1409... .. 3 11 M1410A 6 6 M1411... .. 13 0 M1415... .. 1 4 M1420... .. 6 M1423... .. 3 M1424... .. 6 M1425... .. 4 M1426A 6 M1427-1 7 M1428A 2 1 M1432A 6 M1432-2 (Should read M1413-2) 2 3 M1435 3 M1436... .. 2 1 M1438-1 doz. 2 0 M1439A 1 2 M1463A 7 10 M1631... .. 2 2 M1632-1 2 6 M3402-2 1 5 0 M3403-2 1 5 0 M3410-1 9 0 M3412-1 13 4 M3417... .. 3 4 M3418... .. 3 4 M3421A-1 16 6 M3422A-1 16 5 M3424A-1 4 0 M3425A-1 4 0 M3430A-1 19 6 M3431A-1 19 6 M3433A 4 0 M3434A 4 0 M3442... .. on application M3443... .. on application M3444... .. on application M3445... .. on application	
M1226... .. doz.	8	M1379...	0		
M1227A	6	M1380A	1 7		
M1228...	6	M1381A-1	1 4		
M1229... .. doz.	1 10	M1382A-1	0		
M1230...	1 8	M1383A-1	1 0		
M1231... .. doz.	11	M1385-2	4		
M1232A-3	6 10	M1386-1	1 0		
M1234A-1	4	M1388-3	12 4		
M1235-1 (chrom. plate)	3 6	M1389...	4		
M1236A	4	M1390...	7		
M1237A-1	1 0	M1391...	3		
M1238A-1	1 2	M1392A	4		
M1239...	5	M1393A	4		
M1242A	5	M1394A	6		
M3291... .. 1	16 0	M2763-1	12 9		
M3293-1 (chrom. plate)	1 2	M2764A	1 9		
M3294-1	0 0	M3301-1	9 8		
M3292-3 (chrom. plate)	14 0	M3303...	3 6		
M3244-4 (chrom. plate)	4 6	M3305A-1	1 7		
M3251-1 (chrom. plate)	8 6	M3306-1	4		
M3252A-1	2 0	M3306-2	5		
Control (Brakes). Spare Parts List, Page 31.		M3340A	3 7 6		
E1035 3		M3345A	3 5		
GD986 1		M3346...	3 0		
GD1203A	5 4	M3347A-1	0 6		
GD1209	4	M3348A-1	7 1		
GD1211	1 8	M3349...	15 0		
GD1217A	5 4	M3350A-1	11 6		
GD1244	8 4	M3351A-1	3 8		
GD1247	3	M3352A-1	5 10		
M279 doz.	2 0	M3361A	11 6		
M752 2 8		M3364A	5 7		
M753 1 3		M3380A	1 0		
M757 6		V1309A	2 8		
M758 doz.	2 0	V1310A	3		
M759 7		V1311	3		
M769 3		V1312A	10		
M763A	10	V1313	3		
M764 6		V1314	3		
M765 4		V1321A	1 10 0		
M763-1	4	V1322...	5 4		
M1335...	3 0	V1323...	1 8		
M1336...	1 0 0	V1324	2 0		
M1368A	9	V1325A	1 0		
M1370...	1 8	V1333	2		
M1372A	1 8	V1334	3 4		
M1375...	4	V1335	2 8		
		V1336	4		
		V1337	2 8		
		V1338	3 4		
		V1339	4		

