



Lamborghini

ISLERO 400 GT

catalogo

pezzi ricambio

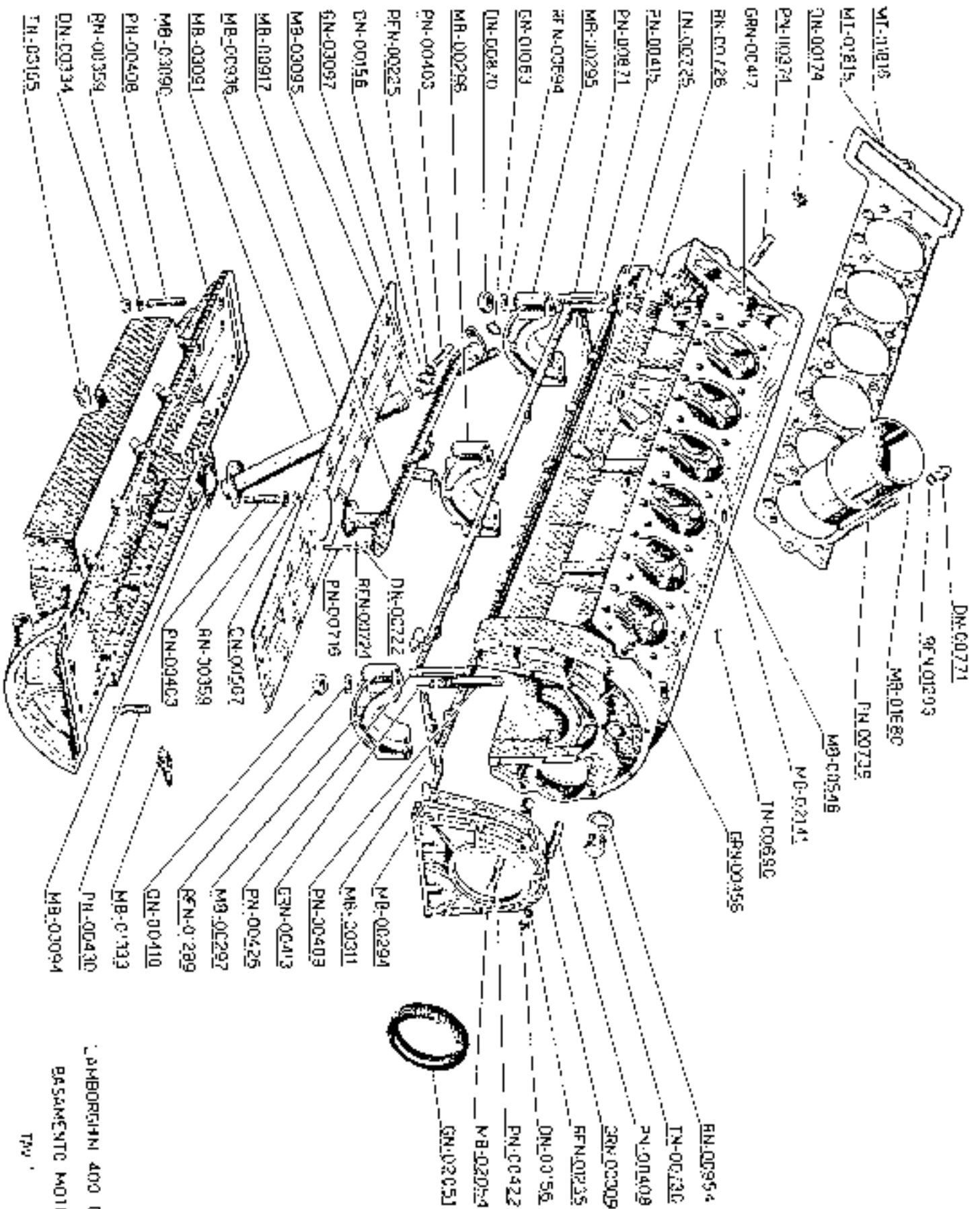

- MT-01818
- MT-01815
- QN-00174
- PN-110374
- GRN-00417
- RN-00126
- LN-002725
- PN-00415
- PN-00871
- MR-00295
- RFN-00694
- GN-01063
- LN-00870
- MR-00298
- PN-00403
- PFN-00225
- CN-00156
- GN-03097
- MB-03095
- MR-00917
- MB-00936
- MB-03091
- MB-03090
- PH-00408
- PH-00359
- DN-00334
- TR-03165
- DN-00771
- RFN-01303
- MR-01880
- PN-00739
- MB-00548
- MB-02141
- TN-00690
- RFN-00455
- DN-00722
- RFN-00724
- PN-00716
- CN-00507
- RN-00359
- PN-00403
- MB-00294
- MR-00311
- PN-00403
- GN-00413
- PN-00426
- MB-00297
- PFN-0289
- GN-00110
- MB-01333
- PN-00430
- MR-00394
- BN-00954
- TN-00730
- PN-01409
- GRN-00309
- RFN-00235
- DN-00156
- PN-00422
- MB-02054
- GN-02051

L. P. H. BORGIANI 400 C° 2-2
 BASAMENTO MOTORE

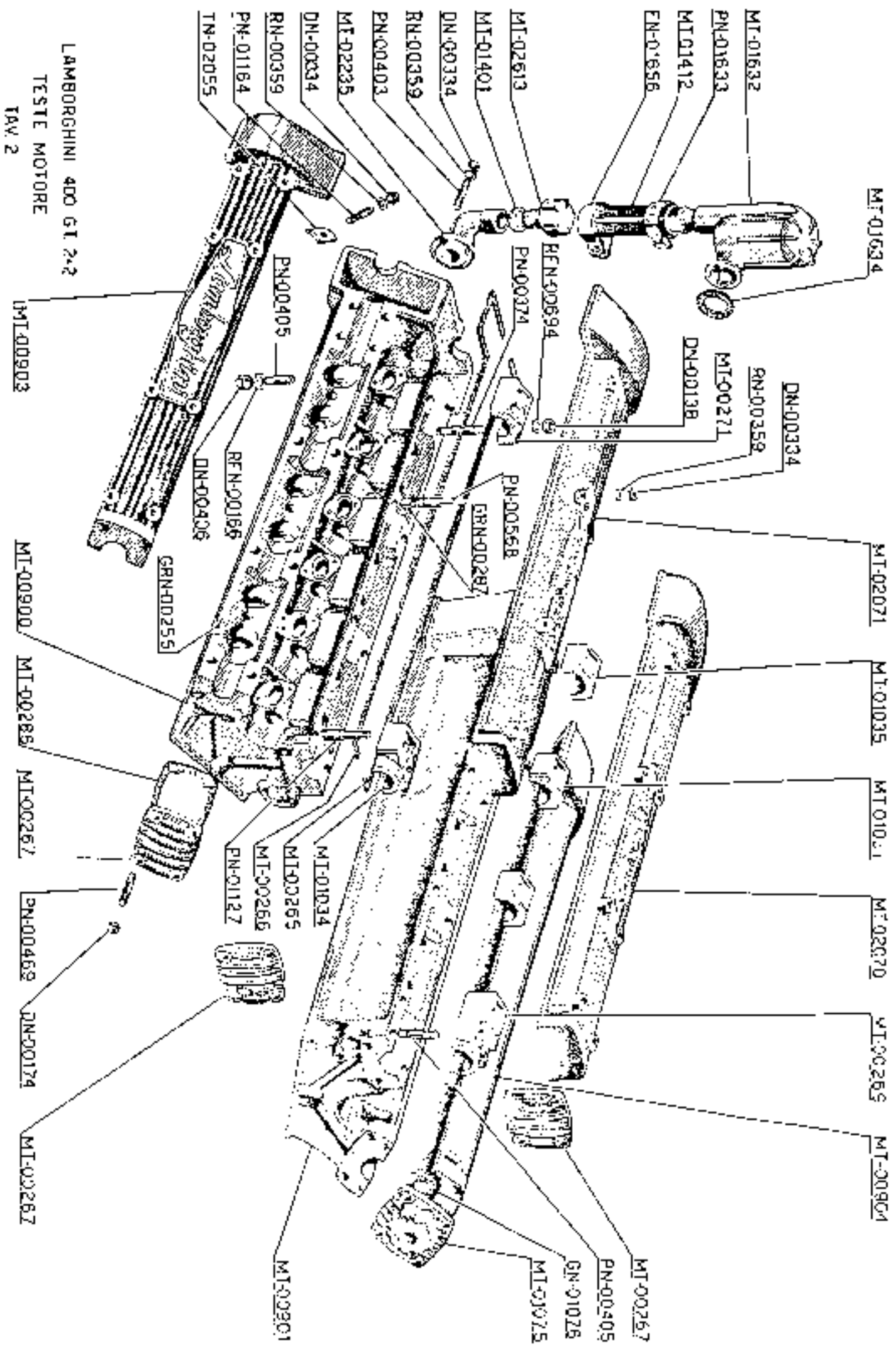

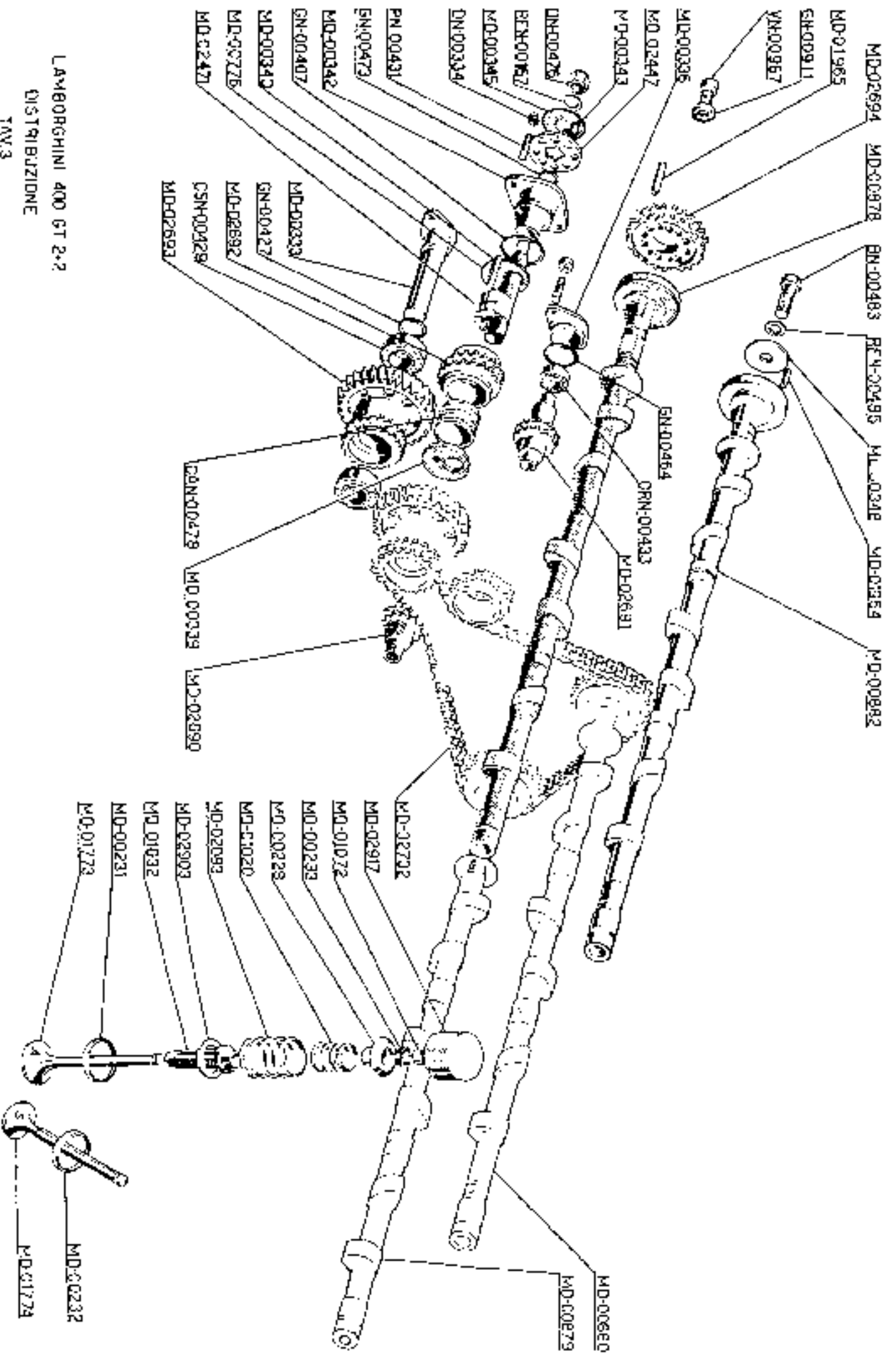

LAMBORGHINI 400 GT 2+2

DISTRIBUZIONE

TAV.3

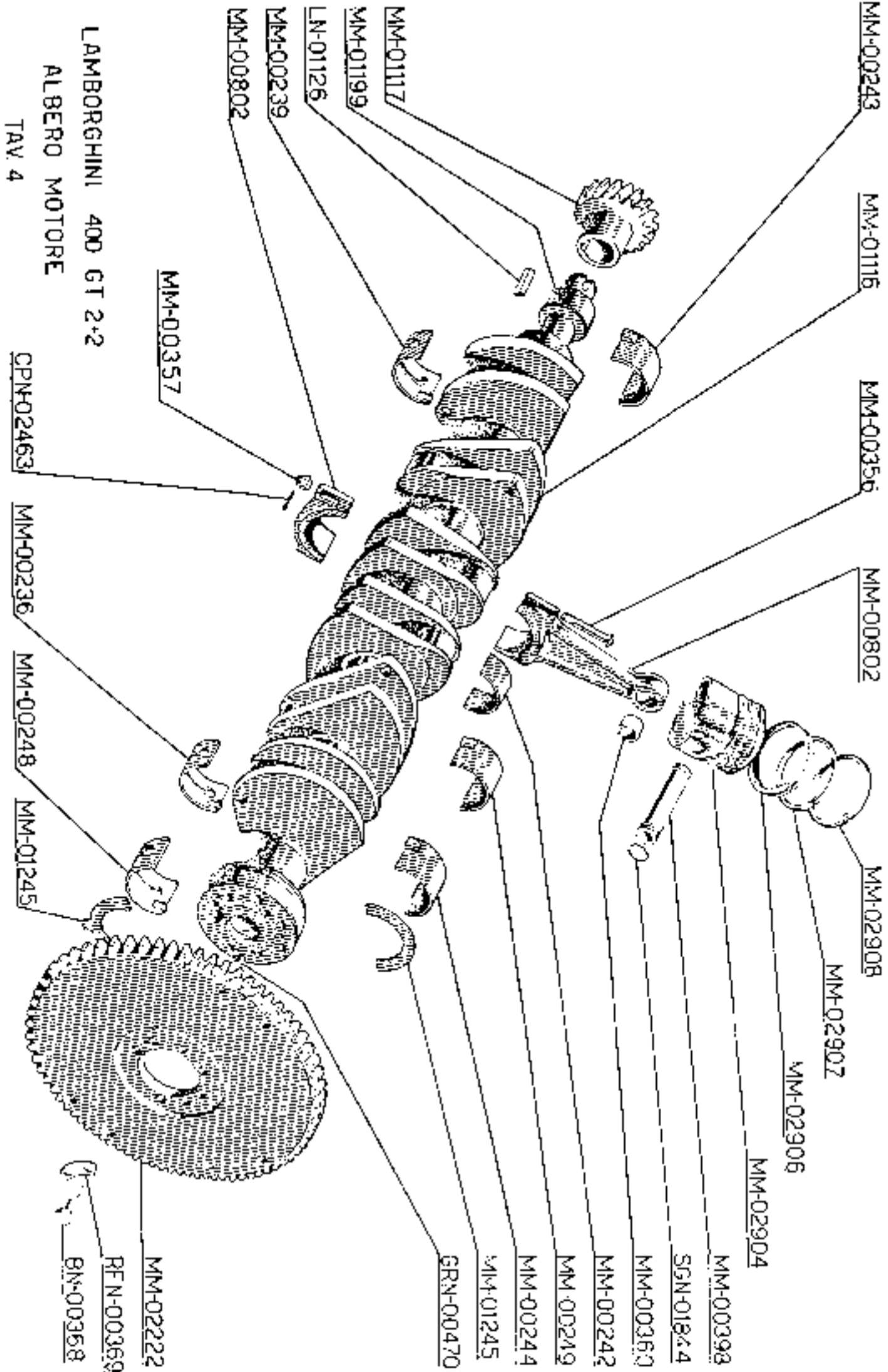

MM-00243

MM-01116

MM-00356

MM-00802

MM-02908

MM-02907

MM-02906

MM-02904

MM-00398

SGN-01844

MM-00360

MM-00242

MM-00249

MM-00244

MM-01245

GRN-00470

MM-01117

MM-01199

LN-01126

MM-00239

MM-00802

MM-00357

MM-02222

RFN-00369

BN-00368

LAMBORGHINI 400 GT 2+2

ALBERO MOTORE

TAV 4

CPN-02463

MM-00236

MM-00248

MM-01245

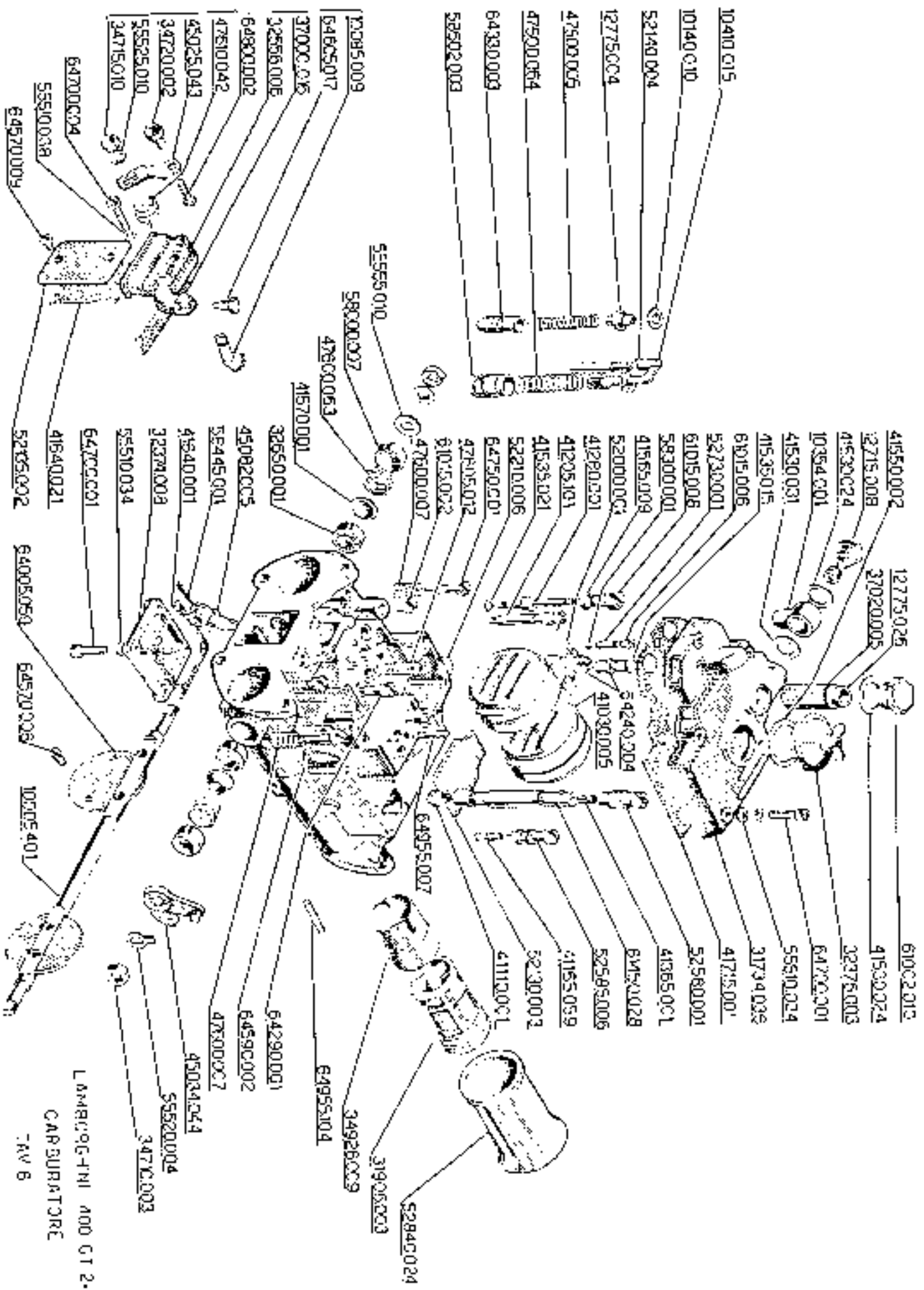

LM4899C-FM ADD CT 2-2
 CARBURETOR
 TAV B

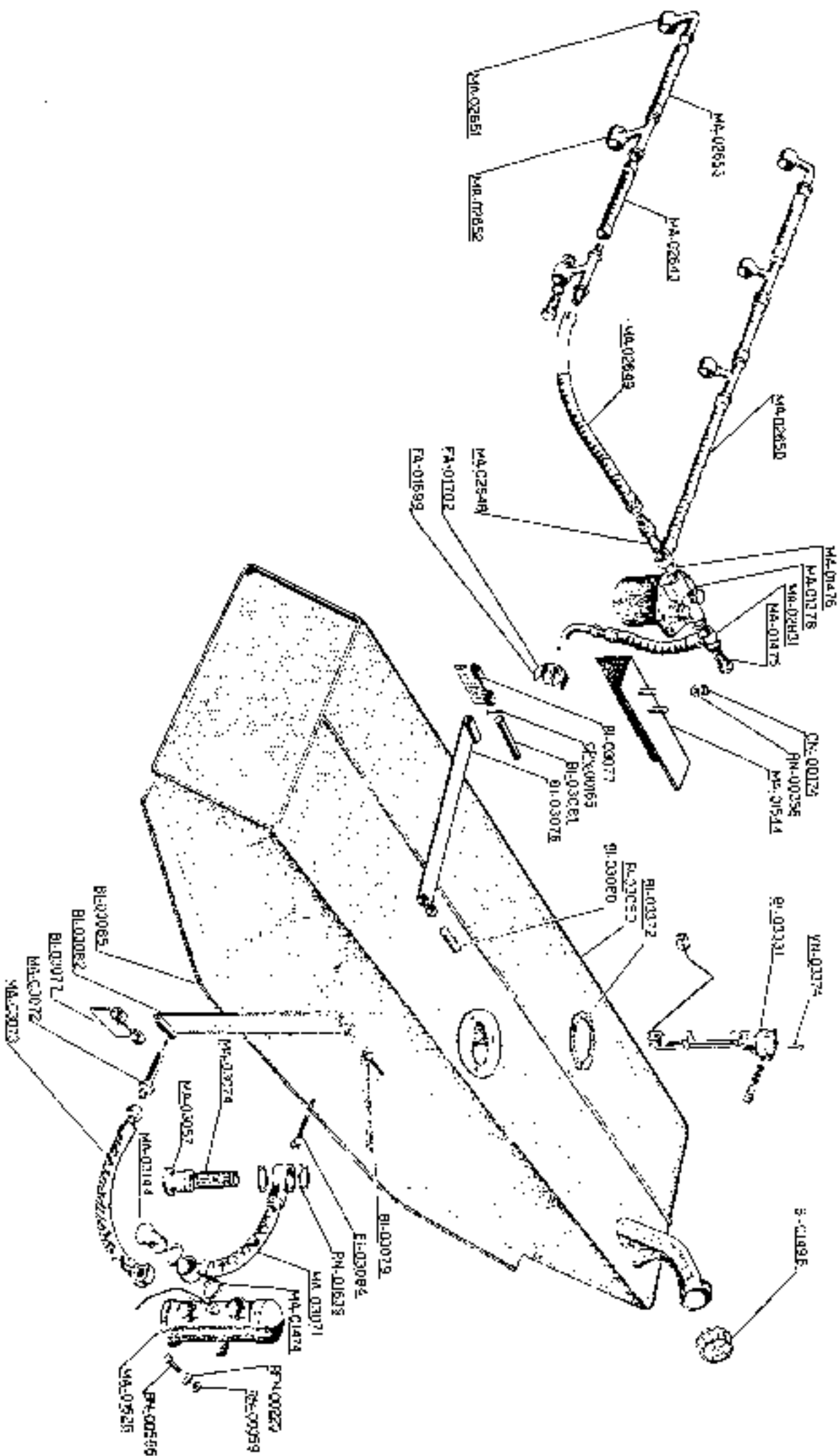

LAMAR-RISHIR 400 6T 2+2

ALIGNMENT

Tab 2

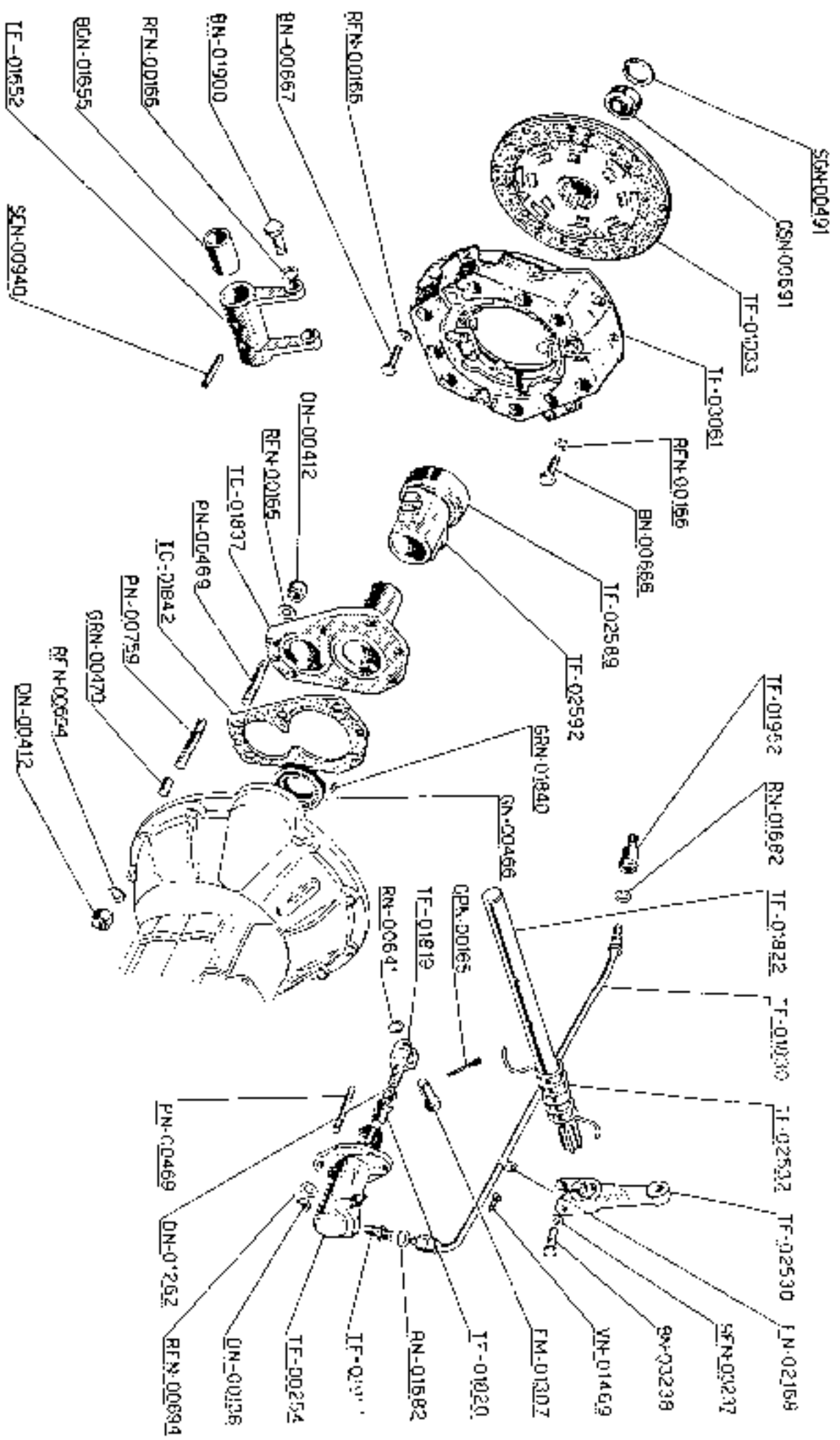

LAVORIGHINI 400 GT 2+2

PAZIONE

TAV. 10

LAMBORGHINI 400 GT 2+2
ALBERO DI TRASMISSIONE

TAV. 13

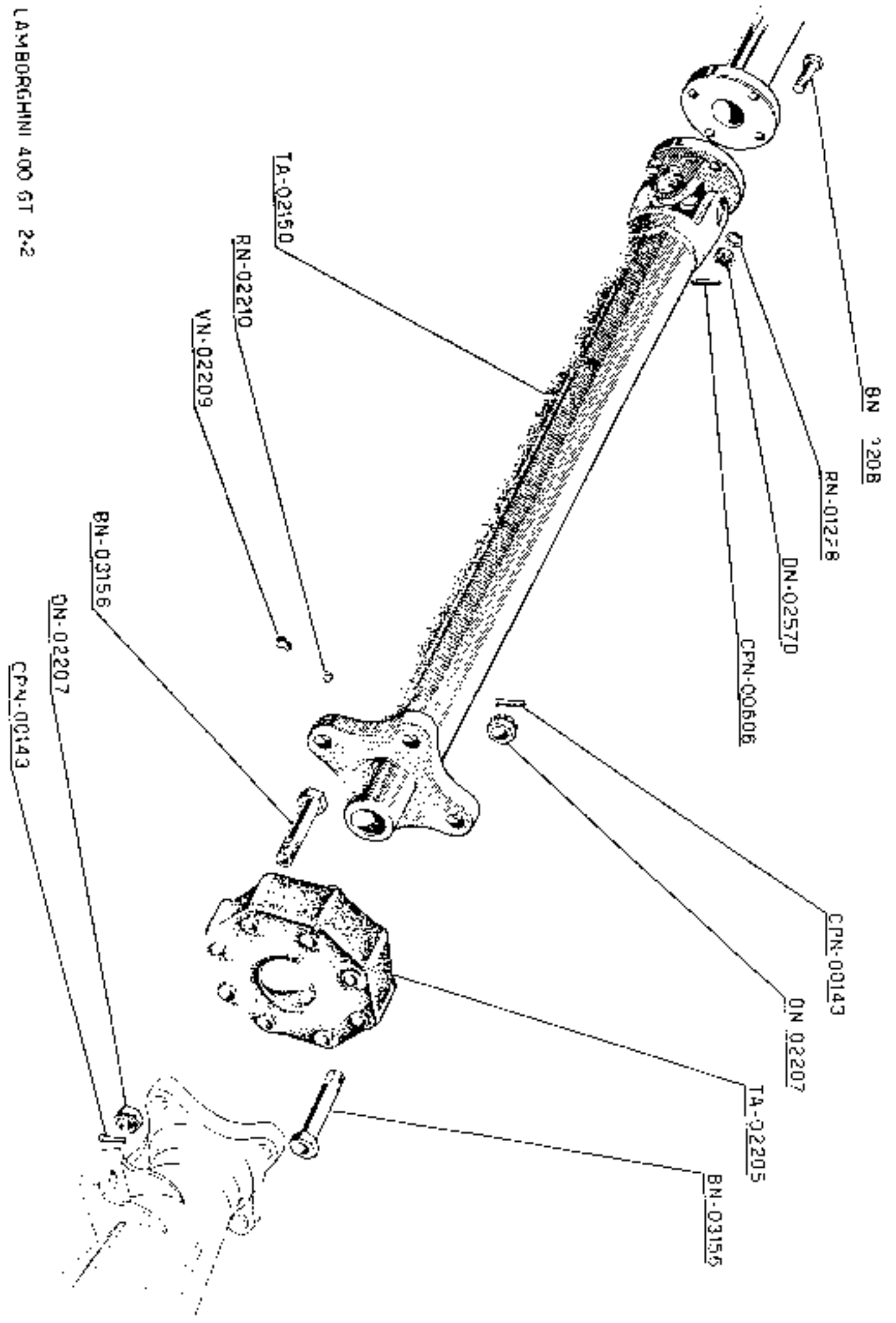

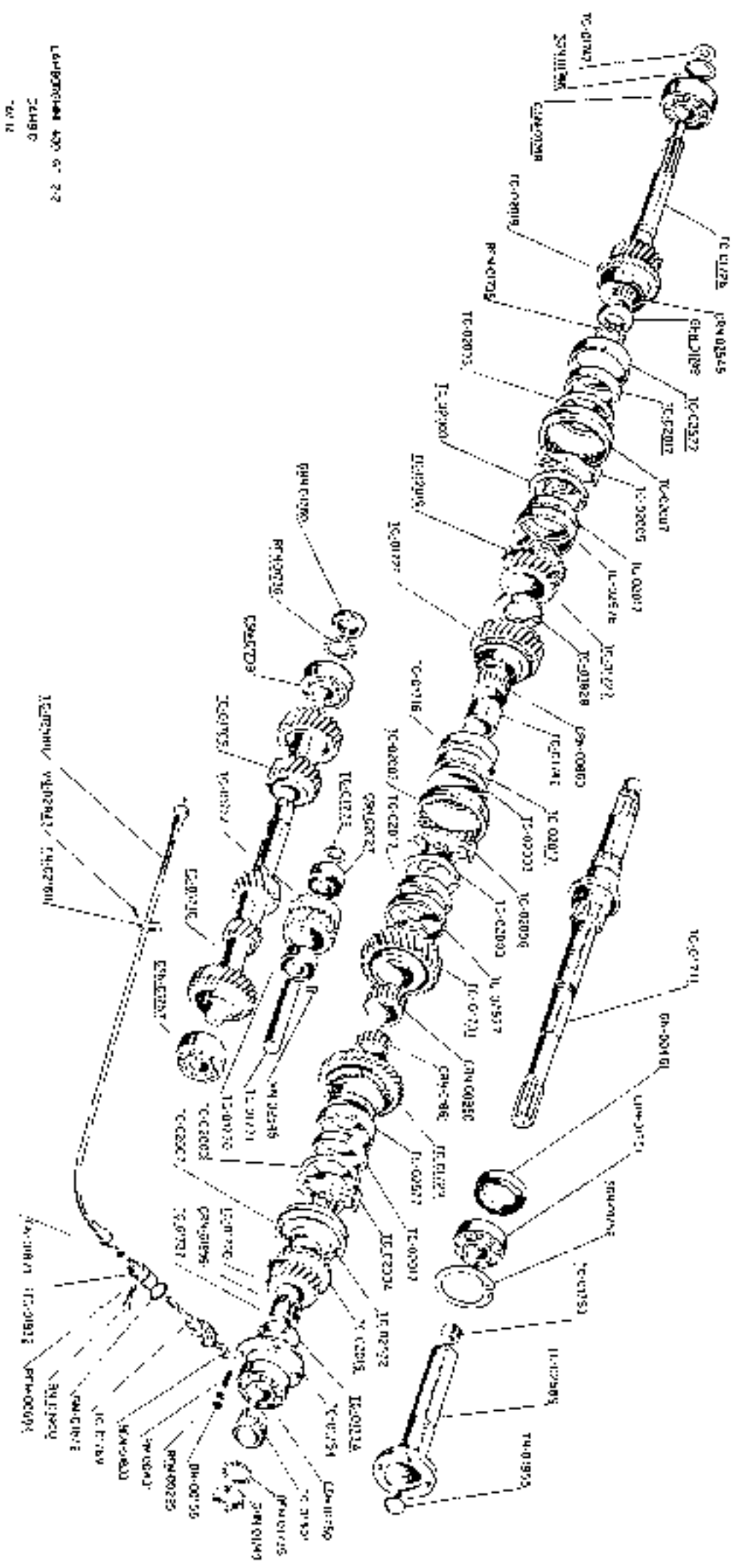

LAMPSON 400 6-2-2
 24810
 7-11

SOSPENSIONE ANTERIORE
LAMBORGHINI 400 GT 2-2

TAV.18

DN-00443

RN-00582

SA-00708

SA-00928

DN-00172

RN-01228

RN-02705

RN-00983

DN-00194

RN-01028

SN-00521

BN-00943

DN-00172

RN-01228

SA-01047

RN-02705

SA-00970

SN-00001

BN-00991

RN-02064

DN-00472

RN-00149

SA-00555

CPN-00143

BN-00979

RN-00978

BN-00982

SA-01056

VN-00968

SN-00002

BN-01218

SA-00527

SA-00961

SA-00526

RN-02564

DN-00174

SA-01981

RN-00163

DN-00194

SA-01548

SA-01991

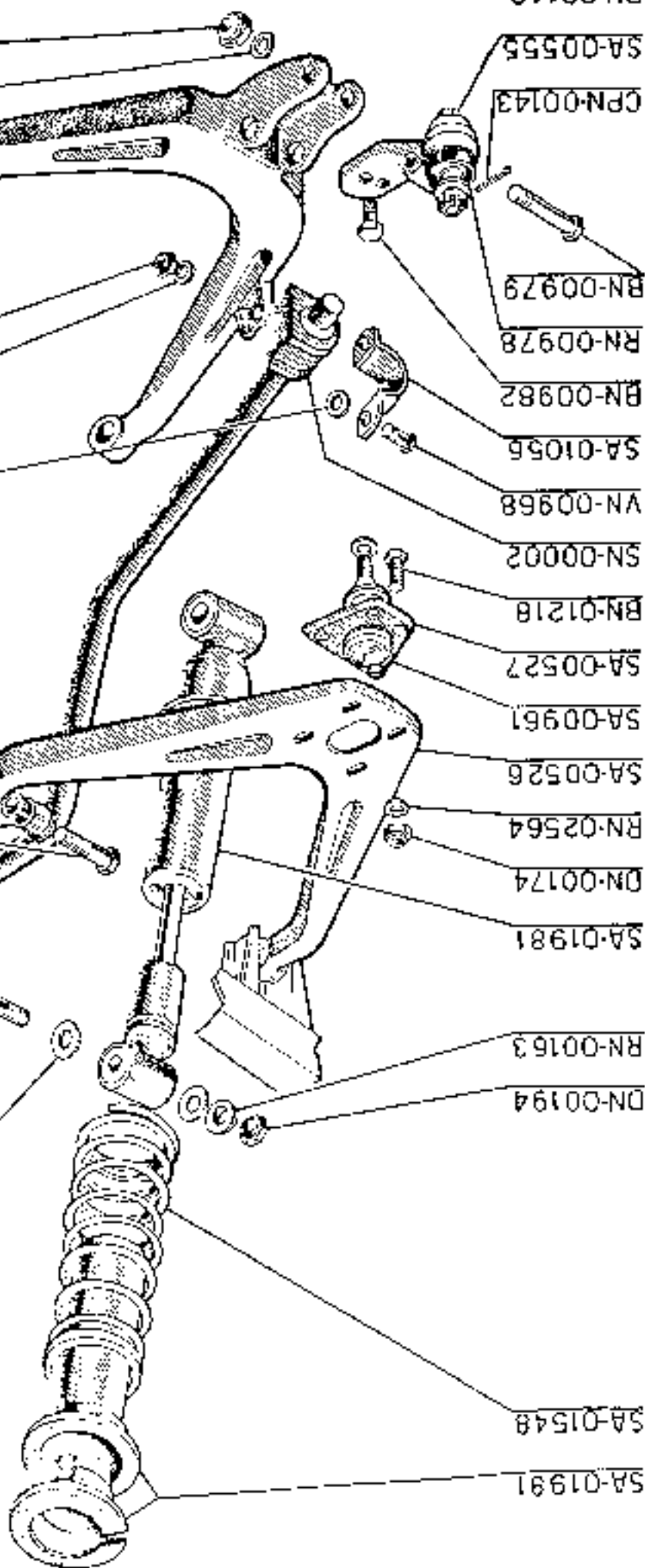

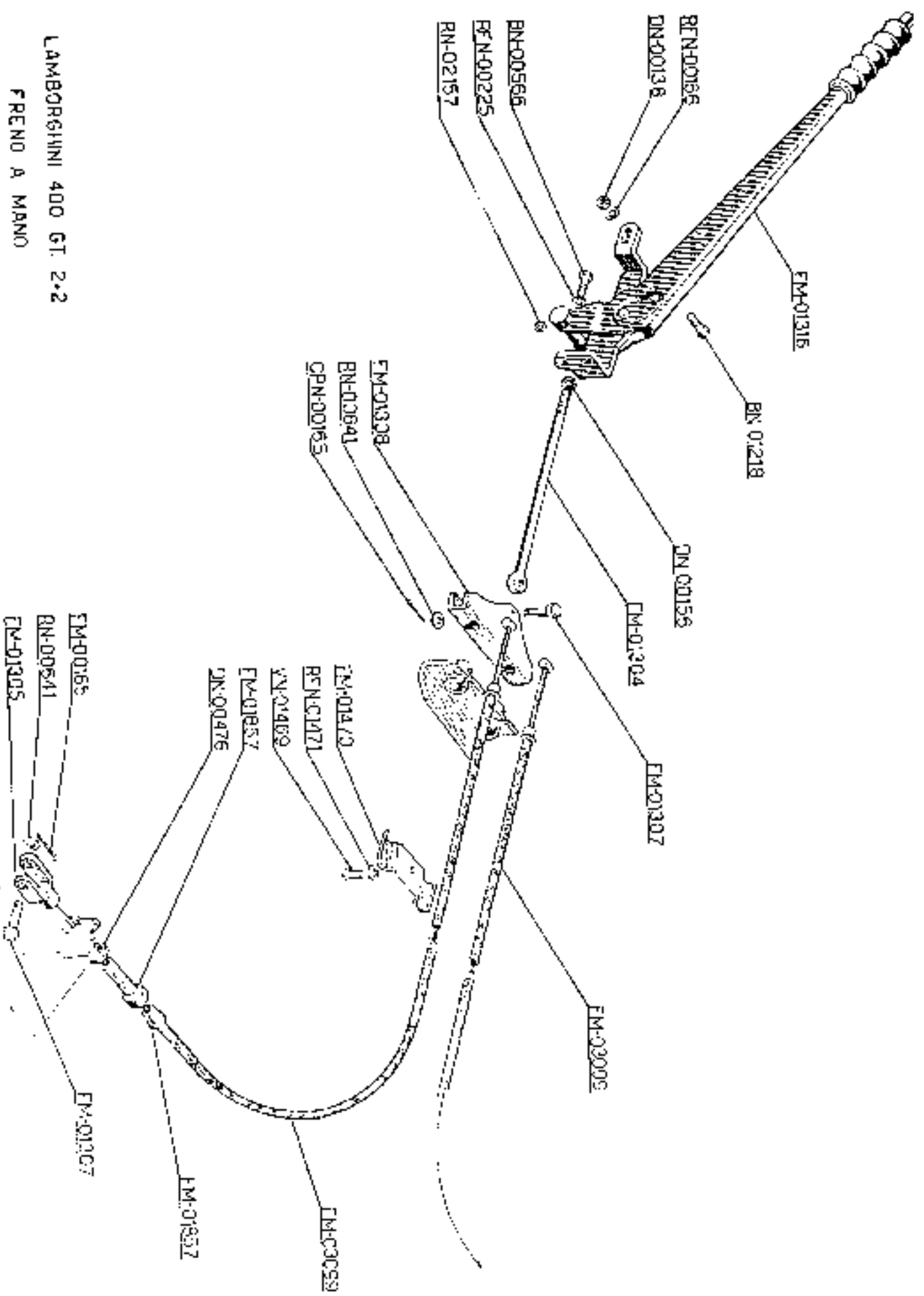

LAMBORGHINI 400 GT 2+2

FRENO A MANO

TAV. 10

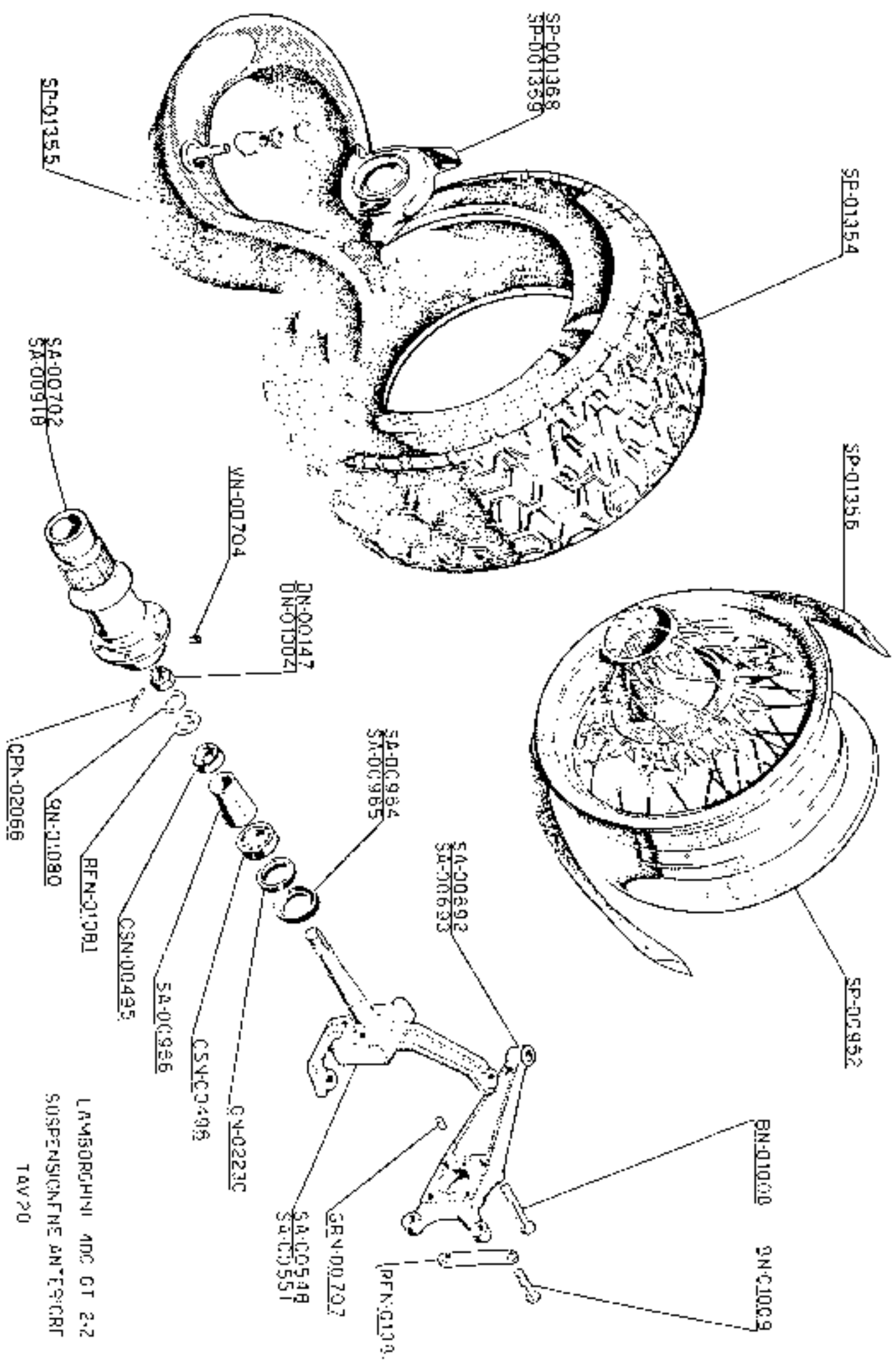

LAMBORGHINI 400 GT 2-2
 SUSPENSION/FINE ANTERIORI
 TAV 20

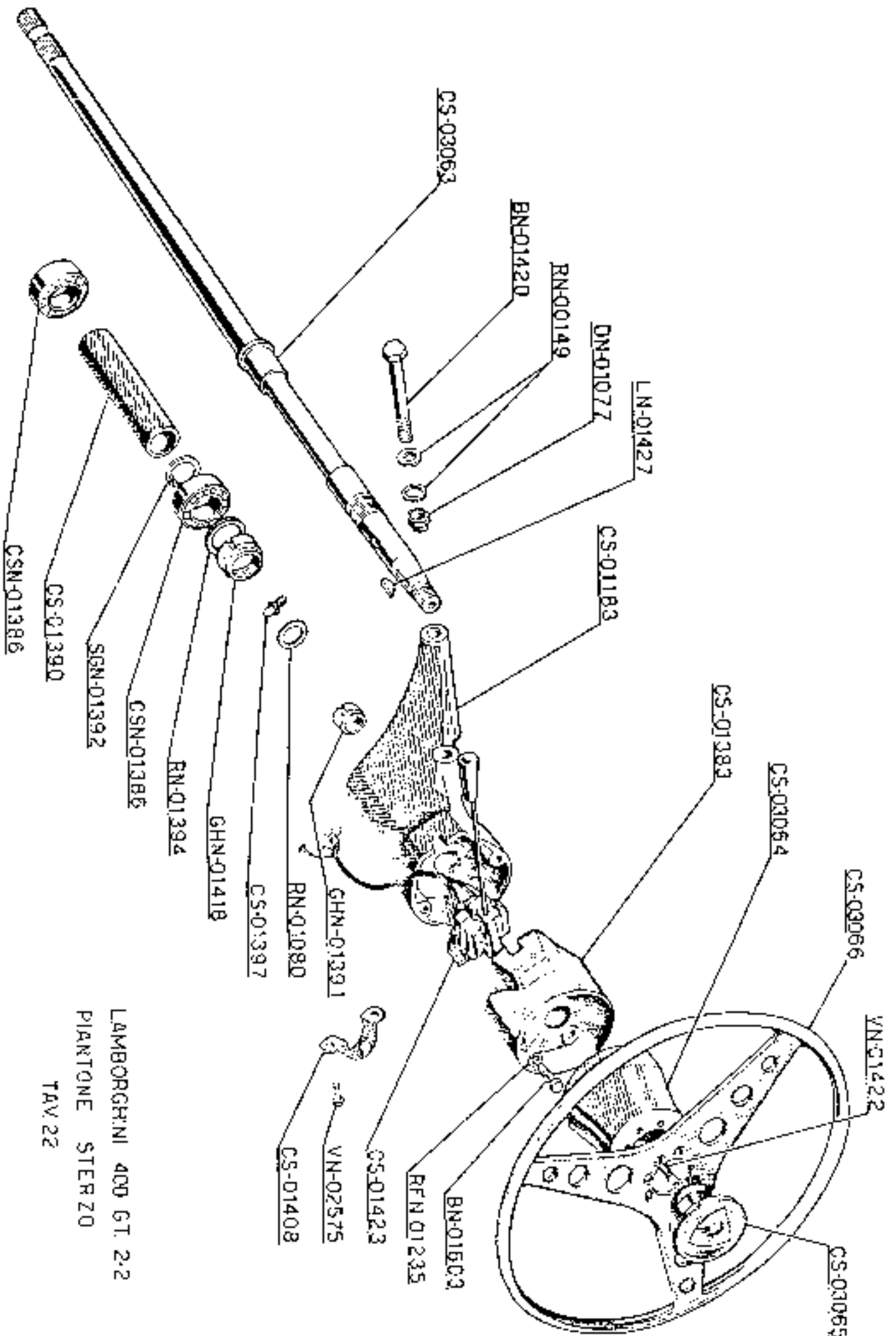

LAMBORGHINI 400 GT 2-2
 PIANTONE STERZO
 TAV 22

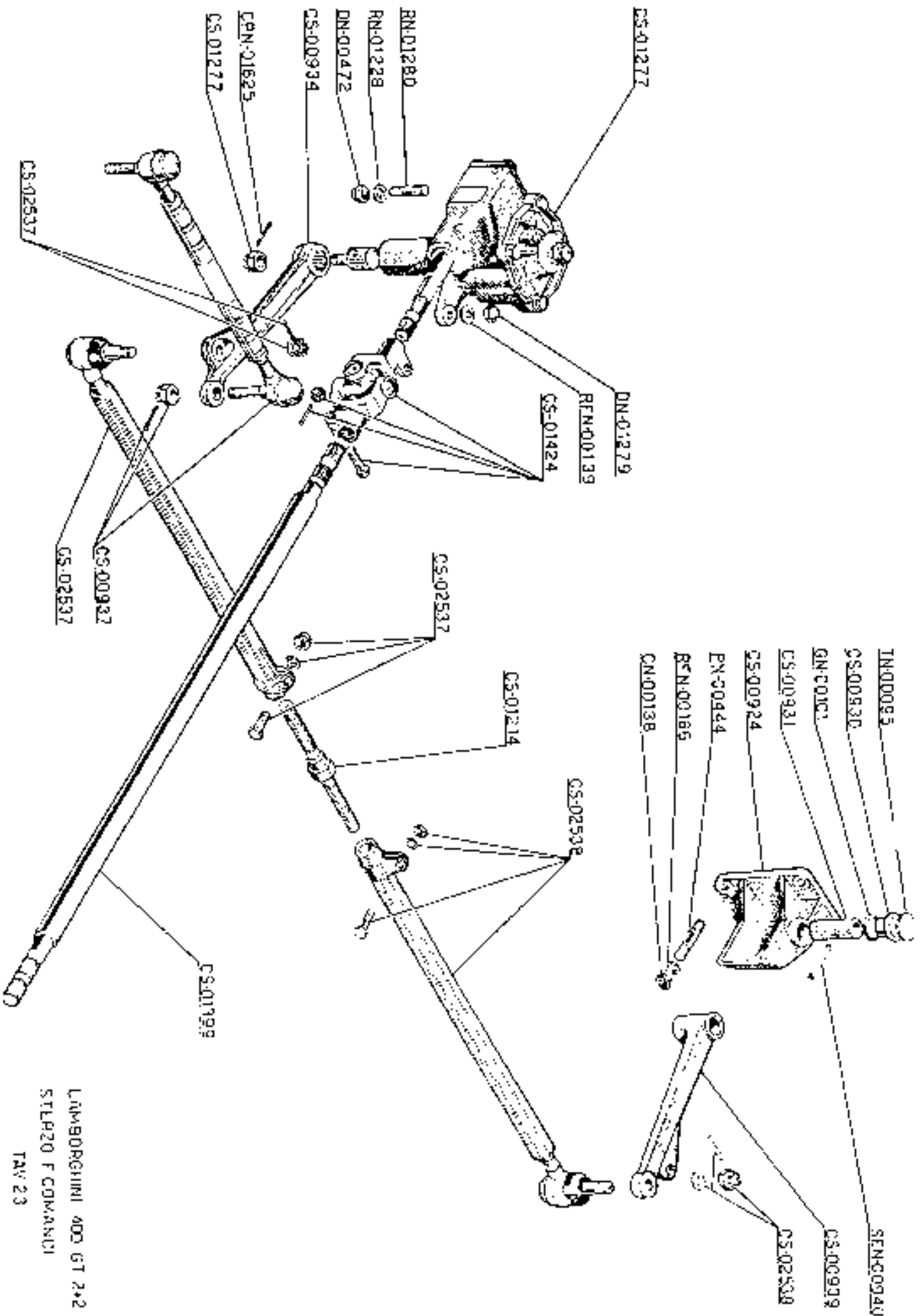

LAMBORGHINI 400 GT 2+2
 STERZO F. COMANCI
 TAV. 23

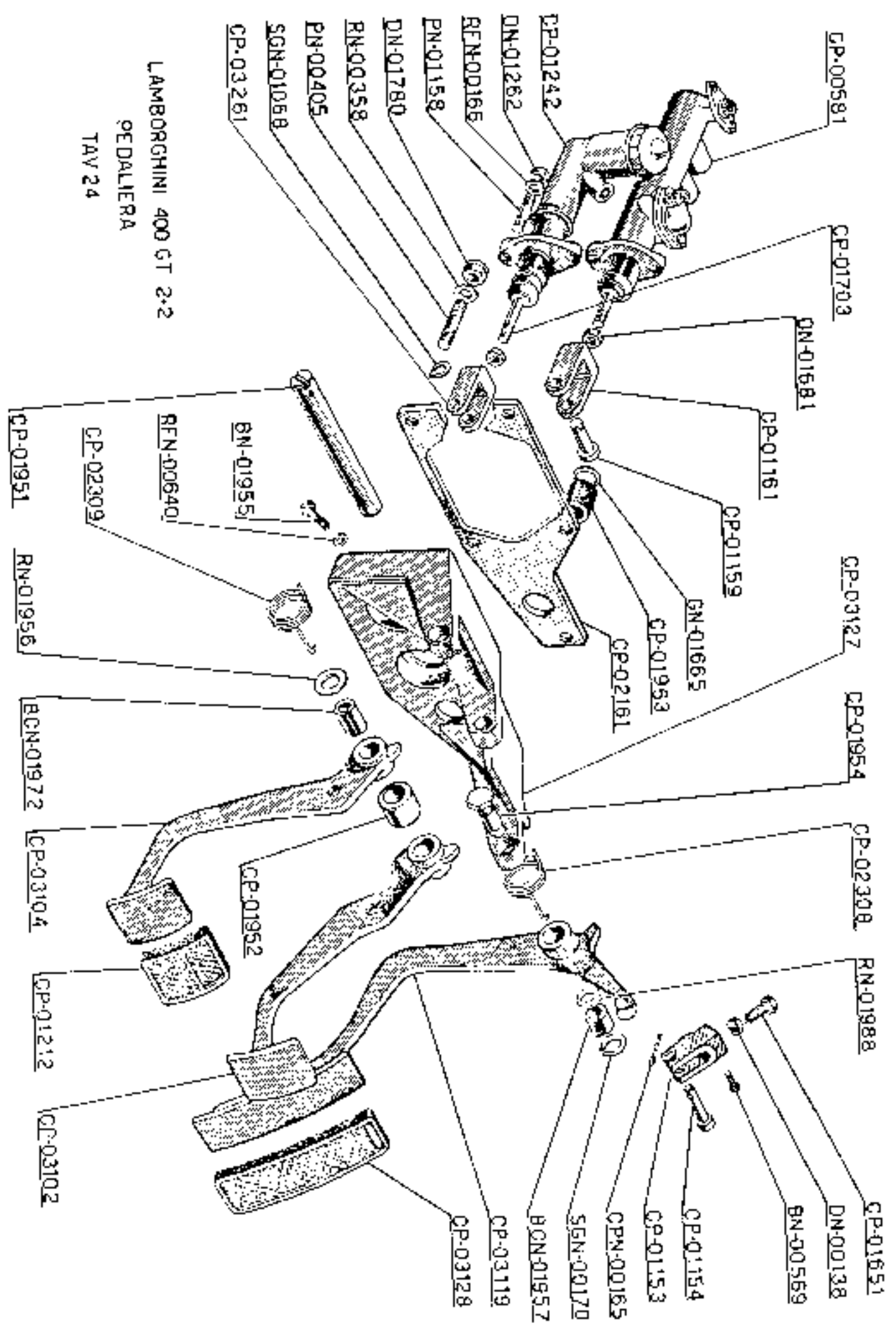

LAMBORGHINI 400 GT 2+2
 PEDALIERA
 TAV 24

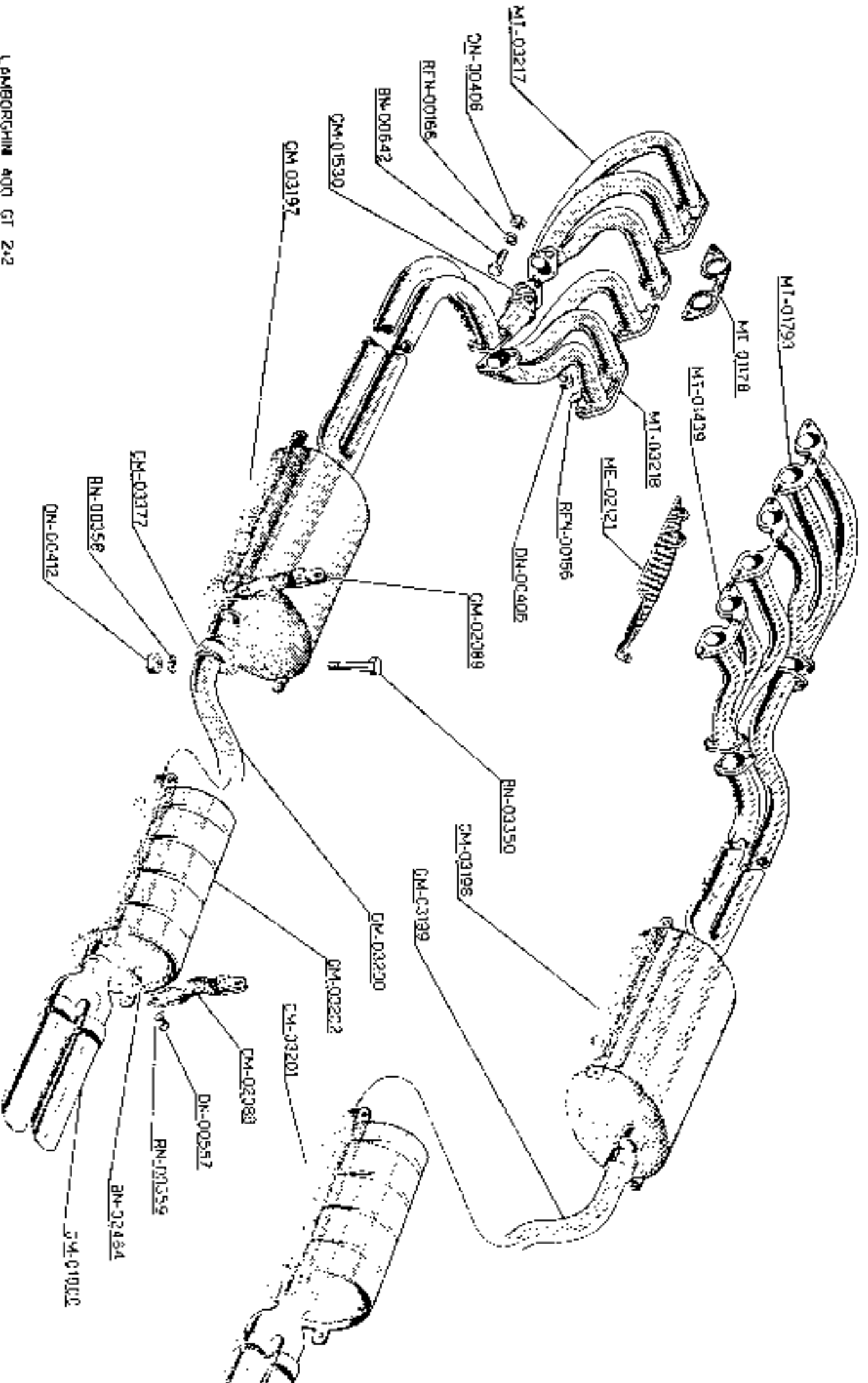

LAMBORGHINI 400 GT 2+2

SILENZIASTORE

TAV. 25

0V-00174 _____ 2V-00053

SH-01931 _____ RN-00401

CT-01307 _____ RN-01137

DN-01077 _____ RN-20426
RN-02228 _____ RN-02119

RT-2028
CT-2029

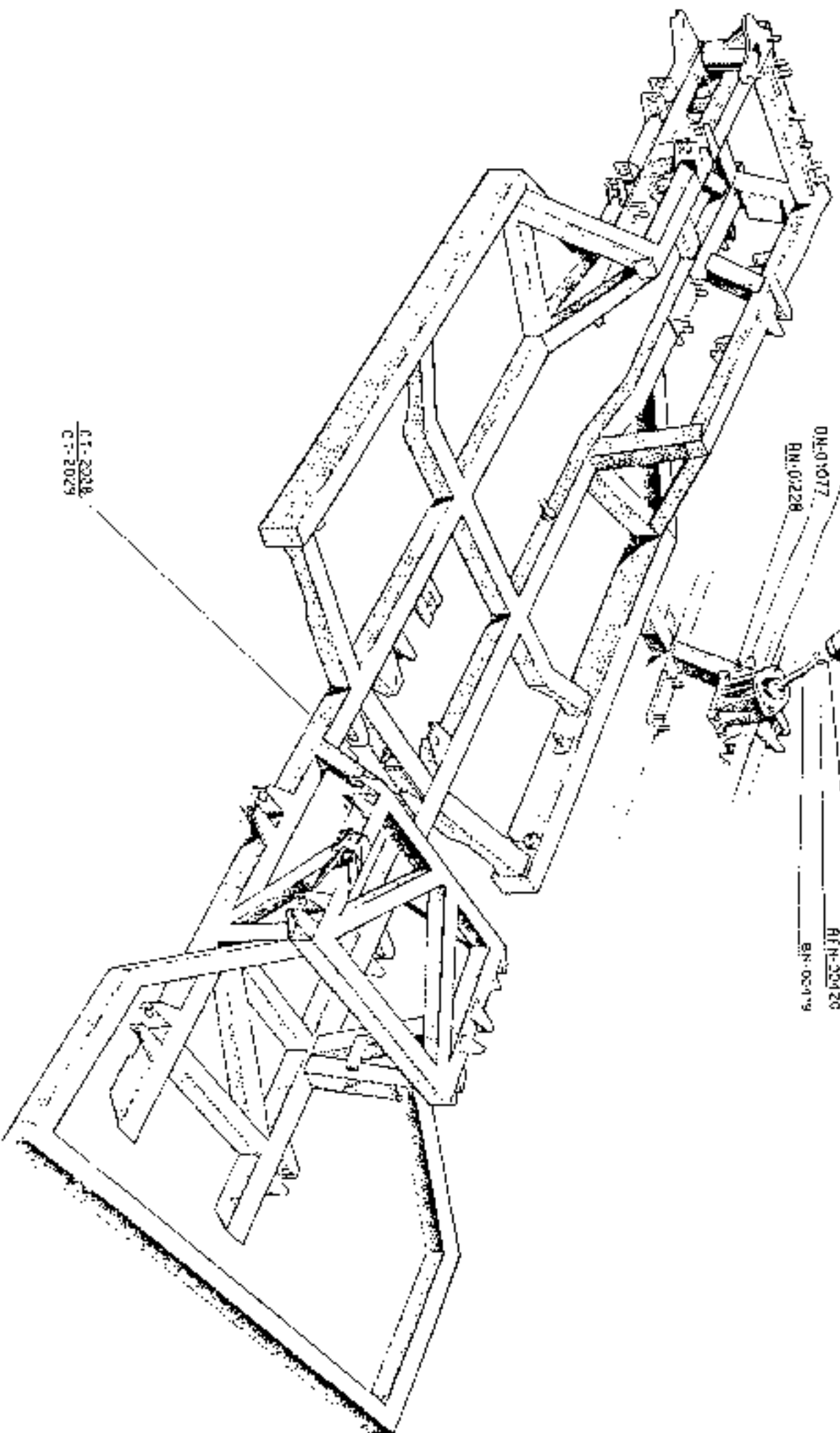

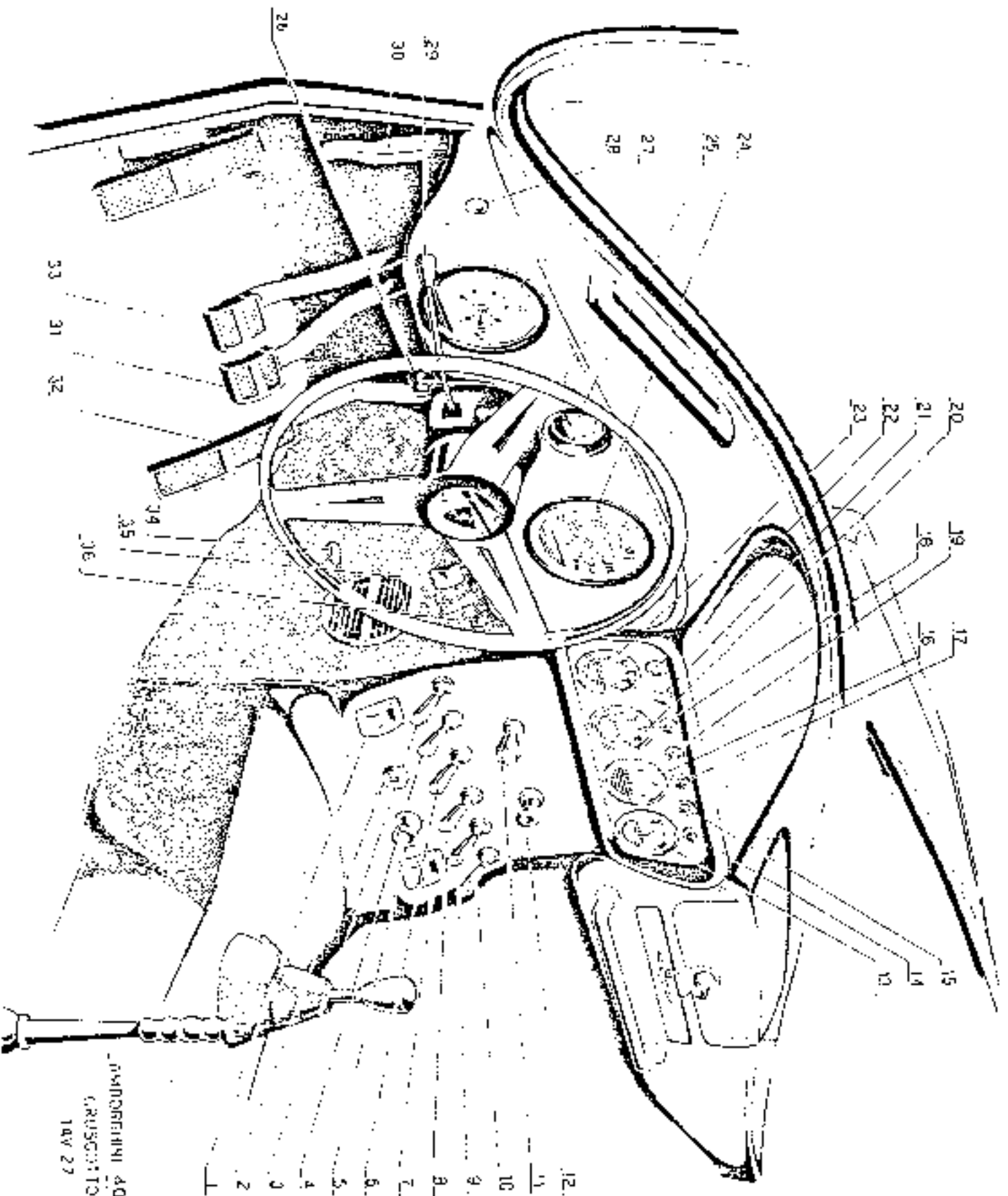

PATENTED APR 27 1927
 G. RUSSELL
 149 27

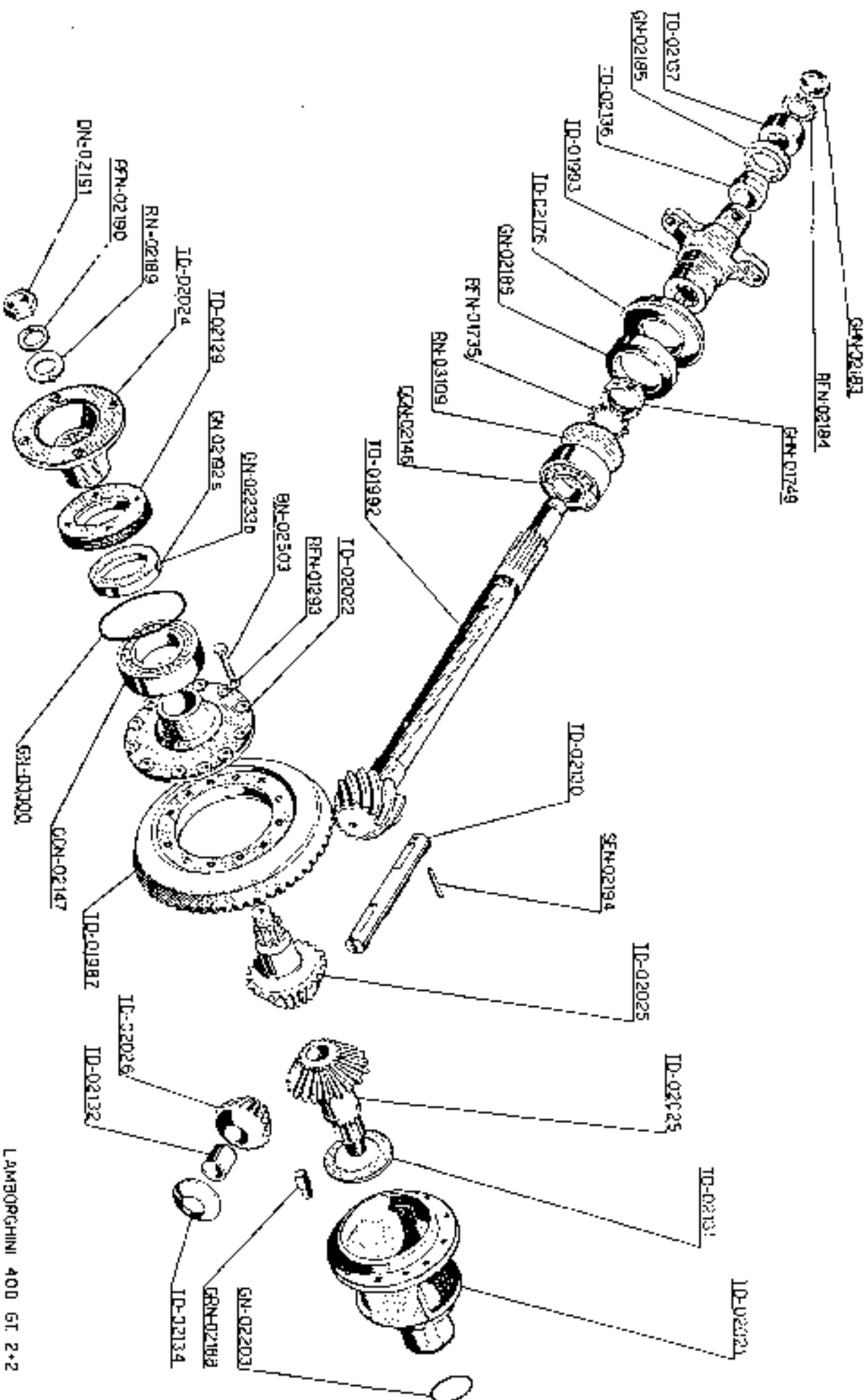

LAMBORGHINI 400 GT 2+2

DIFFERENZIALE

TAV. 28

LAMBORGHINI 400 GT 2.2
SCATOLA DIFFERENZIALE

TAV. 29

